



# GUIDE TO EXTENDING YOUR HOME



**WOKINGHAM**  
BOROUGH COUNCIL



# Welcome

Wokingham Building Control Consultancy has extensive experience and local knowledge of domestic building projects of all sizes and complexity and this guide will take you through the Building Control process. It is not a substitute for professional advice but it aims to show how your project will be affected by the Building Regulations. The guide is divided into chapters that contain advice about typical building projects and it is hoped that when you have read the guide you will have a better understanding of what is involved in a domestic building project.

I hope you find this guide useful, and whether you are using our service for the first time or are a regular customer, we are keen to help deliver your project in a professional and timely manner.

Ben Langford, Building Control Manager,  
Wokingham Building Control

Email: [building.control@wokingham.gov.uk](mailto:building.control@wokingham.gov.uk)

Tel: 0118 974 6376

Website: [www.wokingham.gov.uk](http://www.wokingham.gov.uk)

This publication is available as an E-book:  
[www.extendingyourhome.com/wokingham](http://www.extendingyourhome.com/wokingham)

Solar PV (Electricity) and Solar Thermal (Hot Water)



# SOLAR

Energy Solutions

**GHE Solar are a local family run company based in Newbury, Berkshire. We are MCS registered and strive to provide an honest no pressure service at realistic prices.**

With expert knowledge and experience we are happy to advise on all types of photovoltaic (PV) and solar thermal (hot water) installations from a small roof system to very large ground arrays.



*"GHE solar were recommended by a friend and gave us excellent advice surrounding the prospective installation of solar water heating and photovoltaic electricity generation, and the installation itself was completed on time and with no hassles. I have no hesitation in recommending their services."*

D Bailey (Director of the Greenham Common Trust) - Newbury, Berkshire

Check out more testimonials from satisfied clients at [www.ghesolar.co.uk](http://www.ghesolar.co.uk)

Grange Farm • Long Lane • Newbury • Berkshire • RG14 2TF  
T: 01635 202612 E: [enquires@GHESolar.co.uk](mailto:enquires@GHESolar.co.uk)



# Copper Connexions Ltd

Copper Connexions can offer the following services:

*Inspection and Testing to BS7671*

*Periodic Inspection and Testing to BS7671*

*Domestic Electrical Installation*

*Conforming to Part P  
of the Building Regulations*

*Industrial and Commercial  
Electrical Installation*

Tel: 01344 882781 Mob: 07917 671725

Email: [cconnexionsltd@aol.com](mailto:cconnexionsltd@aol.com)



56A Church Road, Chavey Down, Ascot, Berkshire SL5 8RR

# Terramech Investigations Ltd



Established 1973

[office@terramech.co.uk](mailto:office@terramech.co.uk)  
[www.terramech.co.uk](http://www.terramech.co.uk)

183 Long Lane  
Tilehurst  
Reading  
Berkshire  
RG31 6YW  
Tel: 0118 943 9910  
Fax: 0118 943 9920

**Comprehensive range of services from rapid geotechnical testing of single samples to large scale geo-environmental investigations.:**

Percussive Boreholes  
Machine & Hand Dug Trial Pits  
Window Sampling and Dynamic Probing  
In house Geotechnical Testing & Reporting  
Insitu CBRs, and Field Densities  
Soakage Tests and Design to BRE365

Phase 1 & 2 Environmental Reports  
Varied Contamination Testing Suites  
Gas Monitoring & Risk Assessments  
Water Quality Monitoring & Assessments

**GEOTECHNICAL AND ENVIRONMENTAL INVESTIGATIONS  
LABORATORY TESTING,  
INSITU TESTING AND CONSULTANCY**



# Contents

5

13

29

39

49

57

63

67

Introduction

Domestic Extensions

Loft Conversions

Garage Conversions

Domestic Cellar Conversions

Other Alterations

Radon

Mining



# DREAM

CONSERVATORIES

Online Ltd



**WINDOWS - DOORS - CONSERVATORIES**  
**CONSERVATORY BASES & WALLS**  
**TRADE PRICES / HUGE SAVINGS**  
FREE DRAWINGS, ADVICE AND DELIVERY  
TRADE AND DIY SPECIALISTS

[www.dreamconservatoriesonline.co.uk](http://www.dreamconservatoriesonline.co.uk)

**Phone: 01635 551687**

**Email: [sales@dreamconservatoriesonline.co.uk](mailto:sales@dreamconservatoriesonline.co.uk)**

## Need Sound Tests for Building Control? Planning Conditions Relating to Noise? Noise Likely to Constrain Development?

If the answer is "YES" it looks like you need a noise consultant...

### Sound Insulation Testing

ACCON UK are Berkshire based noise and environmental consultants approved to carry out sound testing between dwellings for Building Control. Since 2004 Approved Document E of the Building Regulations included a new requirement to carry out pre-completion sound insulation tests in a number of situations – specifically when converting properties into multiple dwellings, for new build semi-detached and flatted developments.

ACCON's sound testers are registered with the ANC and we can provide advice on how to improve your sound insulation and design cost-effective solutions when things go wrong. We carry out airborne and impact sound tests with our state-of-the-art equipment and aim to provide real value for money.

### Noise & Planning Issues

ACCON can help you to discharge your planning conditions with respect to noise. Whether it is a noise survey near roads, railways and airports, or you need an assessment for heating, ventilation or air conditioning systems, advice on noise barrier design, or noise control measures for pubs, clubs, restaurants and takeaways etc, then we can provide informed help and advice with the best local knowledge.

Our personnel are Members of the Institute of Acoustics and ACCON UK are members of the Association of Noise Consultants.

For more information, please call 0118 971 0000

Email: [enquiry@accon-uk.com](mailto:enquiry@accon-uk.com)

Or visit [www.noise-consultants.com](http://www.noise-consultants.com)





# Introduction

## Background

Your home is likely to be one of your biggest assets, it is a major long-term investment and over the course of your occupancy your home will have to adapt to the changing needs of you and your family.

Within England and Wales most construction work is covered by the Building Regulations. These are minimum technical standards set by the government and all but the most minor building work carried out must conform to these standards.

The standards cover many aspects of health and safety within buildings as well as energy consumption and accessibility. The Building Regulations are detailed technical standards set to ensure that the building stock within England and Wales is built to a reasonable standard and that it meets the needs of the population.

The Building Regulations are minimum standards, they do not cover quality of workmanship beyond that required to ensure the basic safe construction of the building. It is possible therefore that a building which complies with the Building Regulations may not meet the finishing standards that you require and you should be mindful of this when you are entering into contractual arrangements with your builder.

There is a legal requirement on both the builder and the owner of the building to make an appropriate Building Regulations Application and to comply with the Building Regulations. Failure to do so can result in prosecution through the Magistrates' Court.

This guide will take you through the Building Control process. It is not a substitute for professional advice but it aims to show how your project will be affected by the Building Regulations. The guide is divided into chapters that contain advice about typical building projects and it is hoped that when you have read the guide you will have a better understanding of what is involved in a domestic building project.

## Domestic projects that may require Building Regulations consent include:

- Extensions
- Garage conversions
- Loft conversions



**Absolute  
Mobility**

**Tel: 0800 29 22 110**



Based in Henley-on-Thames, we specialise in supplying and installing accessible bathing equipment directly to individuals, hospitals, care and nursing homes across the UK.

If you or a loved one have problems with mobility, a **walk-in bath**, **accessible shower** or **bath lift** can restore independence:

**Walk in baths** have easy access doors so you can get in and out with just one small step. Also available with assisted lifting mechanisms and detachable seats

**Bath lifts** help you to get in and out of your current bath simply and safely

**Disabled showers** and **wet rooms** come with screen options that make access and assistance simpler

If you would like to browse our accessible baths or showers in person you can make an appointment to visit our Henley on Thames showroom or ask us to bring our mobile showroom straight to your door.



**Address:** **Unit 3 Fairview Works  
Newtown Road  
Henley-On-Thames  
RG9 1HG**

**Telephone:** **0800 29 22 110**

**Email:** **info@absolutemobility.co.uk**

**Website:** **www.absolutemobility.co.uk**

**For Complete Independence  
Choose Absolute Mobility**



- Cellar conversions
- Structural alterations e.g. removing load bearing walls
- Alterations to drainage, hot water or heating systems
- New or replacement windows
- Electrical work
- Replacement roof coverings
- Cavity wall insulation
- Some garages and detached outbuildings
- Some conservatories

If you are considering a building project and you are unsure as to whether it will require Building Regulations consent please feel free to contact us and we will be happy to advise you.

## The Building Regulations Process

If your project needs Building Regulations consent you will need to make a Building Regulations application.

### How to Proceed

Unless you are experienced in construction you will need to get some professional advice. There are a number of ways of obtaining this including:

1. **Appointing an architect/ technician or building surveyor:** these will prepare drawings and designs for your proposal, obtain the necessary approvals and if required they will also help you to find a suitable builder and manage the project for you.
2. **Appointing a design & build company:** these companies offer a one stop shop for construction projects, their design department will prepare the necessary drawings and obtain the necessary approvals and their construction departments will translate these drawings into reality.
3. **Using an experienced builder:** some builders have experience in carrying out

domestic projects and may be able to offer you a package similar to the design & build companies.

## Making a Building Regulations Application

There are two ways of making a Building Regulations application:

### Full Plans Application

This is often thought of as the traditional way of applying for Building Regulations Approval. The building designer will draw up detailed plans and supporting information for the proposed scheme and will send them to us together with an application form and the necessary fee. We will then check the details and following any necessary consultations and liaisons with the building designer a Building Regulations Approval will be issued.

Work can start any time after the application has been received although it is wise to wait until the scheme has had its initial check under the Building Regulations, this usually takes between two and three weeks.

Our team of surveyors will liaise with your builder and inspect the work in progress on site. When the project is satisfactorily completed a Building Regulations Completion Certificate will be issued showing that the project has been independently inspected and that it complied with the Building Regulations.

### Building Notice Application

This system is best suited to small projects carried out by a competent builder and is not recommended unless your builder and designer are very experienced in the type of project that you are undertaking and are fully aware of the requirements of the Building Regulations. Under this scheme no formal Approval of plans is issued and work is approved on site as it progresses.

To use the Building Notice process you or your agent will need to submit a Building

# P. Howlett & Co Ltd

Building Contractors, Heating and Plumbing Engineers & Landscaping Contractors



*The impossible we do immediately...  
...Miracles may take a little longer*



Ian Howlett (Director)  
27 Pinewood Ave  
Crowthorne, Berks RG45 6RR



**Tel:** 01344 773333 • **Mob:** 07770551186

**Fax:** 01344 752202

**Email:** i.howlett@virgin.net • **Web:** www.phowlett.co.uk



Greenham Construction

## DOMESTIC

New builds ■ Extensions & Alterations  
Small Developments

## COMMERCIAL

Schools ■ Churches  
Healthcare & Retail

## INDUSTRIAL

Factories ■ Car Parks ■ Warehouses

T: 01635 200083 ■ F: 01635 203003

Email:

enquiries@greenhamconstruction.com  
www.greenhamconstruction.com



*Calco undertakes all manner of building contracts and in particular specialises in Domestic New Build for developers and private clients*

**Calco** also offers a full range of professional services from concept to completion of a project, including a full design and build service.

Our belief is to build and maintain the highest reputation for quality and service, as reflected by our enviable approved list of sub-contractors and suppliers.

We offer a flexible approach to meeting our clients' needs and deadlines without compromising quality.

**Calco** have an ongoing policy of constantly reviewing and developing the services we provide, ensuring that we are always in a position to rapidly respond to the ever-changing needs of our clients.

**Tel:** 01635 529262 **Fax:** 05601 156780

**E-mail:** info@calco-construction.com

**First Floor Offices, Commercial House,  
53B Kingsbridge Road, Newbury RG14 6DY**

Notice application form together with a site location plan and the required fee. Work can commence 48 hours after the notice has been accepted.

When work commences one of our surveyors will meet with your builder to discuss your intentions, to agree how the work should be carried out, agree when the work will need to be inspected and to establish whether any further information will be required e.g. structural calculations or drawings.

When the project is satisfactorily completed a Building Regulations Completion Certificate will be issued showing that the project has been independently inspected and that it complied with the Building Regulations.

The forms for making a Building Regulations application can be obtained by telephoning or calling into our offices, or you can complete and submit your application online direct from our website.

## Self Certification

To help you to gain Building Regulations approval more easily the government has allowed certain trade bodies to self certify their members' work and to issue Building Regulations certificates. Currently the bodies which can issue these certificates are:

1. **FENSA** – Contractors registered with FENSA can issue certificates for replacement windows.
2. **CERTASS** – Contractors registered with CERTASS can issue certificates for replacement windows.
3. **GAS SAFE** – Registered contractors can issue certificates for installations and alterations to gas, hot water and heating systems so long as the contractor is a registered installer and not just a service engineer.
4. **OFTEC** – Registered OFTEC installers can issue certificates for installation of and alteration to oil burning boilers and appliances.
5. **HETAS** – Registered HETAS installers can issue certificates for installation of and alteration to solid fuel burning boilers and appliances.
6. **Part P** – Electrical Contractors registered under one of the Part P schemes can issue certificates for domestic electrical work.

For a comprehensive and up to date list, please go to the following [www.communities.gov.uk/planningandbuilding/buildingregulations/competentpersonsschemes/existingcompetentperson](http://www.communities.gov.uk/planningandbuilding/buildingregulations/competentpersonsschemes/existingcompetentperson)

## Tips for using Self Certified Contractors

1. Always ensure the contractor is registered for the work they are undertaking, eg. If you are having a new heating system installed ensure the contractor is a registered installer not a service engineer.
2. Always ensure that at the end of the job the contractor issues you with a Certificate confirming that the work complies with the Building Regulations, you may need this when you come to sell your property.
3. If you are in any doubt about anything either contact the relevant trade association or contact your local Berkshire Building Control Authority for advice.

## Other Permissions you may Require

**Planning Permission:** many domestic alterations will also require Planning Permission, further advice is available from the Planning Portal

[www.planningportal.gov.uk](http://www.planningportal.gov.uk) or to confirm whether Planning Permission will be required for your project please either contact one of our Planning Officers or download and complete the householder enquiry form from our website. Full details are available on the inside back cover.

**Party Wall Act:** if your proposal affects a Party Wall or if you will need to excavate foundations close to your neighbour's house you may need to give them notice under the Party Wall Act. This is a Civil Act and your local Berkshire Building Control Authority do not have any enforcing power under the Act. Further details of this can be found on the Planning Portal [www.planningportal.gov.uk](http://www.planningportal.gov.uk) or contact us for the latest guide to the Party Wall Act.

## The Inspection Process

Whatever type of project that you are undertaking we will arrange to carry out a series of inspections of the work in progress. Whilst we cannot be on site all of the time the inspections will be carried out at key stages so that we can be reasonably sure that the work carried out complies with the Building Regulations. We will tailor the inspections carried out to suit your individual project and we will generally arrange these inspections with your builder. If during the project you

have any concerns, if you want something specific inspecting, or if you would like to meet to discuss any issues please contact us and we will make the necessary arrangements.

## Materials & Workmanship

Ensuring your building work is carried out using adequate and proper materials, and in a workmanlike manner is critical. Therefore it is important that you use materials, products and components etc that conform to appropriate British Standards, Euro Codes or are independently certified e.g. British Board of Agrément (BBA). Please therefore contact your building control surveyor to check the suitability of a particular material/building component before using on your building project.

## Completion Certificates

When your project has been satisfactorily completed under the Building Regulations we will issue a Completion Certificate. This is a legal document that you will need if you want to sell your house, you may also need it for re-mortgaging or insurance purposes. Please ensure that we are called in to carry out our final inspection at the end of the project to ensure that your Completion Certificate is issued.



# Building Products

Call us now to discuss your requirements

Your 1st choice for  
**Rainwater  
Harvesting**

**Supplying you all the Specialist Building Products needed to complete your project!**

- Keystone Lintels
- Concrete Padstones
- Multi-foil Insulation
- Roofing Accessories
- Underground Drainage
- Keylite Roof Windows
- Contractors Equipment
- UPVC Fascias & Soffits



Call our  
Sales Team

**0118  
987 3344**

Email: [sales@snsbp.co.uk](mailto:sales@snsbp.co.uk)  
Arkwright Rd, Reading RG2 0LU

## SNS Building Products

Specialist Supplier to the Building Industry

Check out our latest offers now!

Visit [www.snsbp.co.uk](http://www.snsbp.co.uk)

The No.1 Local Family Firm that Cares...



- Windows • Doors
- Conservatories • Soffits

10 YEAR INSURANCE BACKED GUARANTEE



Reading  
**0118 37 66 800**

Fax: 0118 3766802

[www.alphawindows.co.uk](http://www.alphawindows.co.uk)  
email: [sales@alphawindows.co.uk](mailto:sales@alphawindows.co.uk)

Showroom at: 396 London Road, Earley, Reading RG8 1BA

## **C.J. TURNER & SONS** **ROOFING & GENERAL BUILDING**

*Loft Conversion Specialist*

*Quality Workmanship  
Design & Planning Service*

FREE SURVEY & ESTIMATE  
PROFESSIONAL FAMILY FIRM

**01628 477275**  
**Mobile: 07885 586688**

[www.loftconversionsmarlow.co.uk](http://www.loftconversionsmarlow.co.uk)

51 Churchill Drive, Marlow, Buckinghamshire

## **R.D. Brett (Electrical Contractors) Limited**

Lower Nursery,  
Sunningdale  
Berks SL5 0PA  
Tel: 01344 620444  
Fax 01344 624873

email: [enquiries@rdbrett.co.uk](mailto:enquiries@rdbrett.co.uk)



Domestic, Commercial & Industrial Installations

Electrical installations, repairs and maintenance

Rewires and replacement consumer units

Single and Three Phase distribution systems

Testing & Inspection to BS7671 for Landlords certificates and Sale of Property

Insurance Purposes

Health and Safety

Fire Alarm and Emergency Lighting Installations

System Design and CAD Drawings



## **M N Builders**

Tadley, Hampshire  
Mobile: 07770 868 757  
Tel: 0118 9821914  
[info@mnbuilders.co.uk](mailto:info@mnbuilders.co.uk)  
[www.mnbuilders.co.uk](http://www.mnbuilders.co.uk)

M&N Builders are providing the highest standard and quality of building work within the Hampshire and Berkshire areas.

Our services include:

- Extensions & Conversions
- New Builds
- Renovations & Refurbishments
- Residential & Commercial
- Fully Insured Contractors
- Warranted Builders
- Guaranteed and Underwritten



Please contact us for free help and advice along with full written quotations

# Domestic Extensions

**Introduction:** if you need more space and you do not want to move house you may wish to consider extending your home. Your home is probably your most valuable asset so it is important that your extension project is carefully planned. This guide is not a substitute for professional advice but has been written to provide you with useful information about how the Building Regulations will affect your extension.

**Suitability:** most houses are suitable for extending, providing that you have the space. When you are thinking about whether your house is suitable for extending you might like to consider:



Ground Floor Plan.

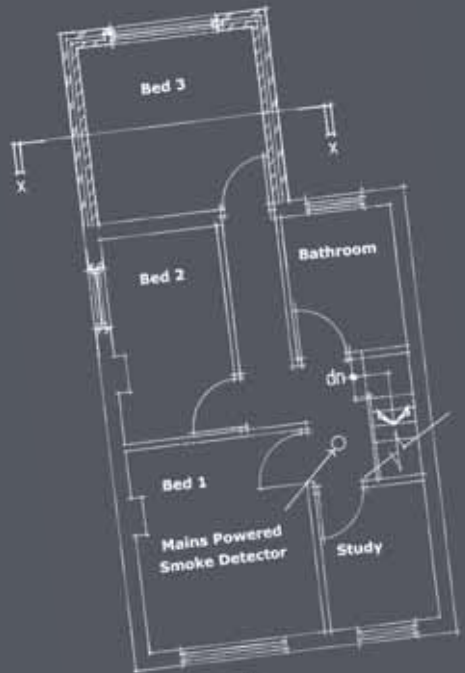

First Floor Plan.



*Traditional or Contemporary?*



*Your Kitchen Your Lifestyle Your Choice*

For a free, no obligation kitchen plan  
and quotation, please contact us on  
**0118 969 3100**

Or alternatively please visit our website  
[www.sandfordmills.co.uk](http://www.sandfordmills.co.uk)



Certain ground conditions will affect the ground floor detail

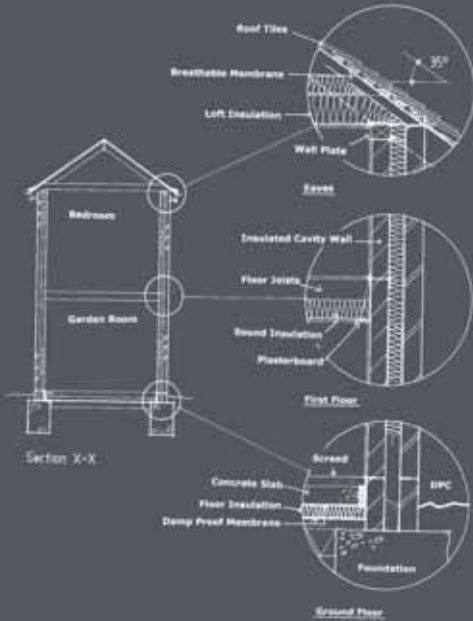

1. How will you access your extension?
2. What effect will your extension have on the circulation in and around your home?
3. What effect will your extension have on your existing house and garden? Will it block out light from existing rooms or make some rooms unusable? Will you still be able to get into your garden?
4. Is your existing house built from an unusual construction for example prefabricated panels, concrete frame etc?

If you can resolve all of these issues then your house may well be suitable for extending.

**How to Proceed:** extensions are complex projects and unless you are experienced in construction you will need to get some professional advice. The introduction contained advice about obtaining this and with this in place we can now consider some of the technical issues that affect domestic extensions.

## Technical Issues

**Foundations:** the foundations are one of the most important parts of your extension and often one of the most expensive.

For domestic extensions trenchfill foundations are the most common, these should be taken down into firm natural ground and should generally be a minimum of 1m deep. In areas with clay subsoil trees up to 20m away can have a significant effect on foundations which generally means that they need to be deeper, sometimes as deep as 2.5m. If you are concerned about any trees please get in touch with us and we will give you some advice regarding foundation depths.

**Ground Floor:** the ground floor of your extension performs a number of tasks: it must support the floor loading, keep out damp and provide thermal insulation. Generally a ground floor is a multilayer structure, the top soil under the extension





*For all your home  
improvement needs*



**Extensions**



**Kitchens**



**Bathrooms**



**Flooring**

We deliver a one stop solution from design and specification  
to ordering and building or installation.

CONTACT US FOR A NO OBLIGATION QUOTE.

Tel: 0118 935 3275 Mob: 07815 901618

E-Mail: [caskip@homecall.co.uk](mailto:caskip@homecall.co.uk)

Web: [www.caskip.co.uk](http://www.caskip.co.uk)





YOUR HOME IS PROBABLY YOUR MOST VALUABLE ASSET SO IT IS IMPORTANT THAT YOUR EXTENSION PROJECT IS CAREFULLY PLANNED.

floor area is removed and a layer of compacted stone is placed over the site. This is blinded with sand and a layer of 1200g polythene is then placed over the sand and lapped in with the damp proof course in the wall (in certain areas, it may be necessary to protect the development from radon, a naturally occurring radioactive gas, by the installation of a suitable membrane at floor level. With the closure of many mines in the south east stythe gas and methane protection will also be required, as a 1200g polythene barrier will not provide adequate protection, if in doubt contact your local area office). A layer of insulation is then provided and a concrete slab at least 100mm thick is poured over the insulation. The concrete can either be float finished or a screed applied at a later date. On some sites where the ground floor is significantly higher than external ground level or where the site has been affected by trees, a suspended floor may be needed, these can be formed from either concrete or timber and if you need any

guidance regarding suspended floors, please get in touch with us for advice.

**Walls:** the walls of your extension must carry the loads from the floors and roof, keep the weather out of the extension and provide thermal insulation. Cavity walls are commonly used for domestic extensions. These are made up from bricks and blocks and the cavity is filled with insulation as the work proceeds. When building walls remember to ensure that you have adequate buttressing at the corner of your extension, lintels over all openings, wall ties to join the leaves of your cavity wall together and a suitable damp proof course. If you are building up against your neighbour's house you will also need to ensure that your wall provides adequate sound resistance.

**First Floor:** two storey extensions will require a first floor, these are generally made up from timber floor joists which span between load bearing walls, they support floor boarding above and plasterboard is then fixed to the underside of the joists to provide

Casa Interiors, a Berkshire based interior design consultancy focuses on the creation of inspirational interiors, (whether traditional, contemporary or an eclectic mix of both) for both Residential and Commercial clients.

Contact us now to discuss your requirements and take advantage of our FREE initial consultation.

Full interior design service / Fabrics and Wallpapers  
Full curtain making service / Bespoke furniture  
Lighting / Accessories / Bespoke Artwork



01344 319777  
[info@casa-interiors.co.uk](mailto:info@casa-interiors.co.uk)  
[www.casa-interiors.co.uk](http://www.casa-interiors.co.uk)

**casa**

a ceiling finish and fire resistance. The size of the floor joists will depend on the span so please contact us for advice on the joist size required. The floor will also need to include sound insulation and in domestic extensions, 100mm of sound deadening mineral wool placed between the joists is generally sufficient.

**The Roof Structure:** the roof of your extension will need to be designed to keep out the rain and snow and may need to cope with some light loft storage loading. Generally two types of roof are used for domestic extensions:

**Flat Roofs:** this is the simplest type of roof structure and for some extensions, generally single storey, a flat roof can provide a practical and economic solution. Timber joists are used to span between the loadbearing walls and beams and these are covered with a plywood decking laid on firing strips to provide a fall. Thermal insulation is then placed over the roof and it is generally finished with a waterproof covering of three layers of bonded roofing felt. Critical things to consider in this type of roof are the size and support of the roof joists and the way that the roof will be insulated and, if necessary, ventilated.

**Pitched Roofs:** if a flat roof is not suitable for your needs you are likely to require a pitched roof. These are generally more substantial structures that are finished with roof tiles or slates. The supporting structure of the roof can be formed in two ways:

1. **Trussed Rafter Roofs:** these are quick to construct, measurements are taken from site and roof trusses are made up in a factory, they are then delivered to site ready for installation. Each roof is individually designed by the roof truss manufacturer using specialist computer software and the carpenter's time on site can be significantly reduced.
2. **Traditional Roofs:** A carpenter cuts a traditional roof on site. The roof structure will generally be designed by an Architect or Structural Engineer and the timber is then delivered to site where the carpenter will set out the roof and cut each of the individual timbers to size before installing them. This type of roof offers the greatest flexibility in roof shape and is often the only way of roofing complicated extensions especially where the new roof must join onto an existing structure.



# **S & M**

## **BLOCK PAVING**

***WHATEVER YOU NEED, WE WILL PROCEED***

- ***All Types of Driveways and Patios***
  - ***Free Design and Consultation***
  - ***Range of Colours & Patterns***
  - ***Driveways Cleaned and Sealed***
    - ***Shingle Driveways***
    - ***Red and Black Tarmacadam***
    - ***A Full Landscape Service***
    - ***Property Maintenance***
- ***All Work Fully Insured & Guaranteed***

***FROM YOUR LOCAL AREA A FAMILY RUN BUSINESS  
FOR OVER 30 YEARS***

***– FRIENDLY AND RELIABLE –***

***TELEPHONE: 01276 32737***  
***MOBILE: 07747 807412***

The size of the timbers and supporting beams required in a roof will depend on the loadings and spans involved in each case, complex roofs will require a Structural Engineer's design but our Building Control Surveyors will be happy to assist your builder in designing simple roof structures.

Once the support is in place the roof must be covered to provide weather protection, pitched roofs are generally finished with tiles or slates with a layer of roofing membrane or felt under them. The tiles are supported by the rafters via a series of timber battens. To provide adequate weather resistance the tiles overlap each other and they must have an adequate pitch. For extensions it is common to use tiles or slates that match the main house although this is not always possible if the extension roof has a very low pitch. Our Building Control Surveyors will be happy to assist you with any enquiries that you have about roof finishes.

**Stairs:** if your extension has more than one storey you may need to install a staircase and careful design of this can be critical to the success of the extension. If a stair is installed it should be designed in accordance with the following guidance.

**Width:** there is no minimum width for stairs in the Building Regulations however they will

need to be useable. Generally stairs are 850–1000mm wide.

**Pitch:** the maximum pitch for the stair should not exceed 42 degrees.

**Rise and Going:** the maximum rise of each tread of a domestic stair should not exceed 220mm and the going should be at least 220mm.

**Headroom:** the clear headroom over the stair should be at least 2m.

**Handrails and Balustrades:**

the stair should be provided with a handrail at least 900mm high and any exposed edges of stairs or landings should be provided with balustrading at least 900mm high.

**Fire Precautions:** it is important that you consider fire precautions when you are designing your extension. The most dangerous fires generally occur at night when everyone is asleep and to give you awareness of a fire the Building Regulations suggest that mains operated smoke detectors should be installed on each floor of the house when it is extended.

To prevent people being trapped by a fire all rooms that do not open directly onto a hall and all first floor rooms should have a



# HUEY CONSTRUCTION LTD

A Specialist Building Contractor in:

- New Builds
- Refurbishments
- Extensions
- DDA Works
- Renovations
- Loft Conversions
- Alterations & Adaptations

**For a free Consultation, Estimate or Advice,  
please feel free to contact us:**

734-736 Oxford Road, Reading, Berkshire RG30 1EH

Tel: 0118 959 0991

Fax: 0118 956 0724

Email: [info@hueyconstruction.co.uk](mailto:info@hueyconstruction.co.uk)

Web: [www.hueyconstruction.co.uk](http://www.hueyconstruction.co.uk)





window or door that is large enough for people to escape through. If you are using a window as your secondary fire escape it should have a clear opening of at least 0.33m<sup>2</sup> at least 450mm wide with a sill height of between 800 and 1100mm above floor level.

Fire is a very dangerous thing and careful design and planning are required to ensure that the risks it poses are minimised.

**Ventilation:** fresh air is essential to healthy living and the Building Regulations require your extension to have adequate ventilation, generally an opening window with a 'trickle vent' is all that is required, the window should have an openable area equivalent to at least 1/20th of the floor area of the room that it is ventilating depending on the opening angle of the window. The trickle vent is a small slot type vent that you can leave open to allow some background ventilation without the need to open the window, generally these are found in the top of the window frame. If your extension contains a kitchen, utility room or bathroom you will need to provide an extract fan in these areas and your Building Control Surveyor will be pleased to provide you with more detailed advice when they call on site.

**Drainage:** it is usually possible to connect drainage from extensions into the existing drainage systems. Drainage can be divided into two types, foul water and rainwater and generally speaking the drainage systems should be kept separate. Foul drainage is generally discharged through a series of pipes and manholes to a public sewer although some properties will have septic tanks or private sewage treatment plants. When planning your extension look for manholes and try and find out where your drains are running so that you can work out how any new drains will connect to them. It is important that all new underground drain pipes have a diameter of at least 100mm so that they do not block or freeze, are watertight and have manholes or access

points so that any blockages can be cleared. Where possible rainwater drainage should not be discharged to foul sewers as this can cause problems with flooding, the preferred solutions are to discharge rainwater to soakaways located in your garden at least 5m from any building or to storm water sewers if they are available. Please note that you are likely to need approval when building over or adjacent to a public sewer, however we will notify you and Thames Water if this situation occurs. Note also that if your property was built before 1st October 1937 you are likely to have a 'Section 24 Public Sewer'. In this instance you will also need to contact Thames Water to obtain their agreement to your proposals.

**Heating:** most extensions will need to be heated and you will need to check with your heating engineer that your existing system has sufficient capacity to heat your extended house. You may also need to move your boiler, if for example, your extension will cover the flue outlet. Any alterations to your heating system should be carried out by a suitably qualified plumber or heating engineer registered with Gas Safe for gas fired boilers or OFTEC for oil fired boilers. Any new boilers will need to be highly efficient condensing boilers and the new radiators that you install in your extension should be fitted with thermostatic radiator valves so that you can ensure that they use heat efficiently.

**Thermal Insulation:** CO<sub>2</sub> emissions are a major concern in today's environment and you will need to provide a high level of insulation within your extension. Your extension should provide an insulated envelope so that the amount of heat escaping is minimised. The roof, walls and floors of your extension should all include thermal insulation; walls generally have insulation placed within the cavity, roofs generally have insulation in the loft area and sheets of insulation can be placed beneath the concrete of your ground floor.

# CREATING THE PERFECT ENVIRONMENT

**K.W Electric  
(Southern) Ltd.**

*Established  
Since 1954*

Single socket up to Major Projects  
Testing & Inspecting + PAT Testing

Lighting - Interior & Exterior

Warden Systems & Access Control

Fire Alarms • Insurance Work

Part P Registered

All Electricians Qualified

17th Edition

**FREE** Visual Wiring Check on Completion of Works Carried Out

Competitive Rates **Local Authority Approved**

**Domestic & Commercial Electrical Contractors**



**T: 01189 344133**

**F: 01189 341144**

**[www.kwelectrics.com](http://www.kwelectrics.com)**

Another major area where heat is lost from buildings is the windows and these require special attention: 24mm double glazing units incorporating low emissivity glass are generally required and, unless energy improvements are carried out in the existing house, the window area of your extension is limited by the Building Regulations to 25% of the floor area plus the area of any existing openings covered by the extension.

High levels of insulation can result in problems with condensation and care must be taken to ensure adequate ventilation is available to rooms and particularly in roof voids.

As well as insulating your extension you will need to consider the efficiency of any services you put into it. Low energy light fittings should be used where possible and any new heating systems should work to high levels of efficiency and have suitable thermostats and controls.

**Sound Insulation:** to reduce unwanted noise the walls and floor around bedrooms will need to be insulated to reduce sound transmission, this is generally achieved by placing 100mm of sound deadening quilt in the floor void and in the partitions around the bedrooms.

**Electrical Installations:** as part of the Building Regulations process you will need to supply British Standard Test Certificates for most new electrical installations, when selecting your electrical contractor please ensure that they are competent to provide you with these test certificates as otherwise you are likely to incur additional costs for testing the circuits.

**Glazing:** to reduce the risk of people injuring themselves, glazing in and around doors and all glazing within 800mm of floor level should be either toughened or laminated glass.

IT IS IMPORTANT TO ENSURE THAT YOU PLAN YOUR EXTENSION CAREFULLY AND GET THE WORK CARRIED OUT BY AN EXPERIENCED CONTRACTOR.



## Double Glazing Refurbishments



- Misted units, handles, hinges & locking systems
- Also suppliers & fitters of high security windows & doors
- Secure glass & glazing

**0800/0330 999 55 99**

**0118 989 2613**

## Supplying & fitting of award winning Splash Backs

- Any colour for kitchens and bathrooms
- Also supplying glass worktops & table tops
- Mirrors & glass shelves
- As featured in Beautiful Kitchen Magazine



We appreciate that cost is of great importance. We also believe that the quality of service and materials is of equal significance. Whilst we are in no way prepared to compromise on either of these things we are prepared to try and match any written like for like quote.

Should you wish to discuss this or any other matter please feel free to do so on either 0800/0330 999 5599 or email on [info@alldergroup.co.uk](mailto:info@alldergroup.co.uk)



REF: WBC1

**Conclusion:** whereas a well designed and constructed extension is a definite asset to your home that can provide useful extra space and add value to your property, a poorly thought-out extension can reduce your property's value and in some cases compromise your safety and the structural integrity of your home. It is important to ensure that you plan your extension carefully

and get the work carried out by an experienced contractor.

The Building Regulations exist to ensure that buildings are constructed to a reasonable standard; Building Control will be pleased to provide you with any further assistance that you require during the design and construction of your extension.

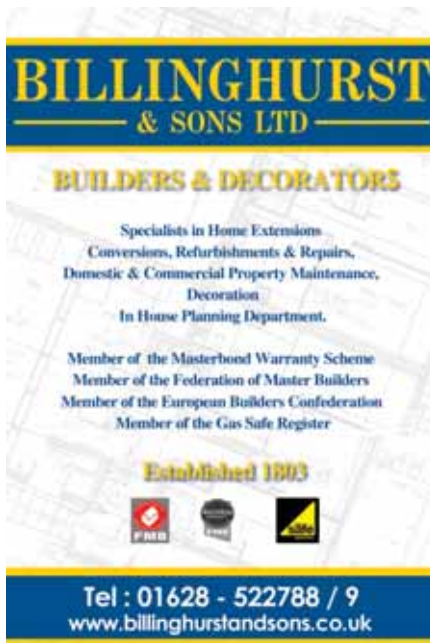



**BILLINGHURST**  
— & SONS LTD —

**BUILDERS & DECORATORS**

Specialists in Home Extensions  
Conversions, Refurbishments & Repairs,  
Domestic & Commercial Property Maintenance,  
Decoration  
In House Planning Department.

Member of the Masterbond Warranty Scheme  
Member of the Federation of Master Builders  
Member of the European Builders Confederation  
Member of the Gas Safe Register

Established 1803



Tel : 01628 - 522788 / 9  
[www.billinghurstandsons.co.uk](http://www.billinghurstandsons.co.uk)

## HICKS BUILDING CONTRACTORS

Est. 1978

- Extensions
- Renovations
- Loft conversions
- Exterior maintenance
- Brickwork specialists
- General builders

**Tel: 07979 991289**

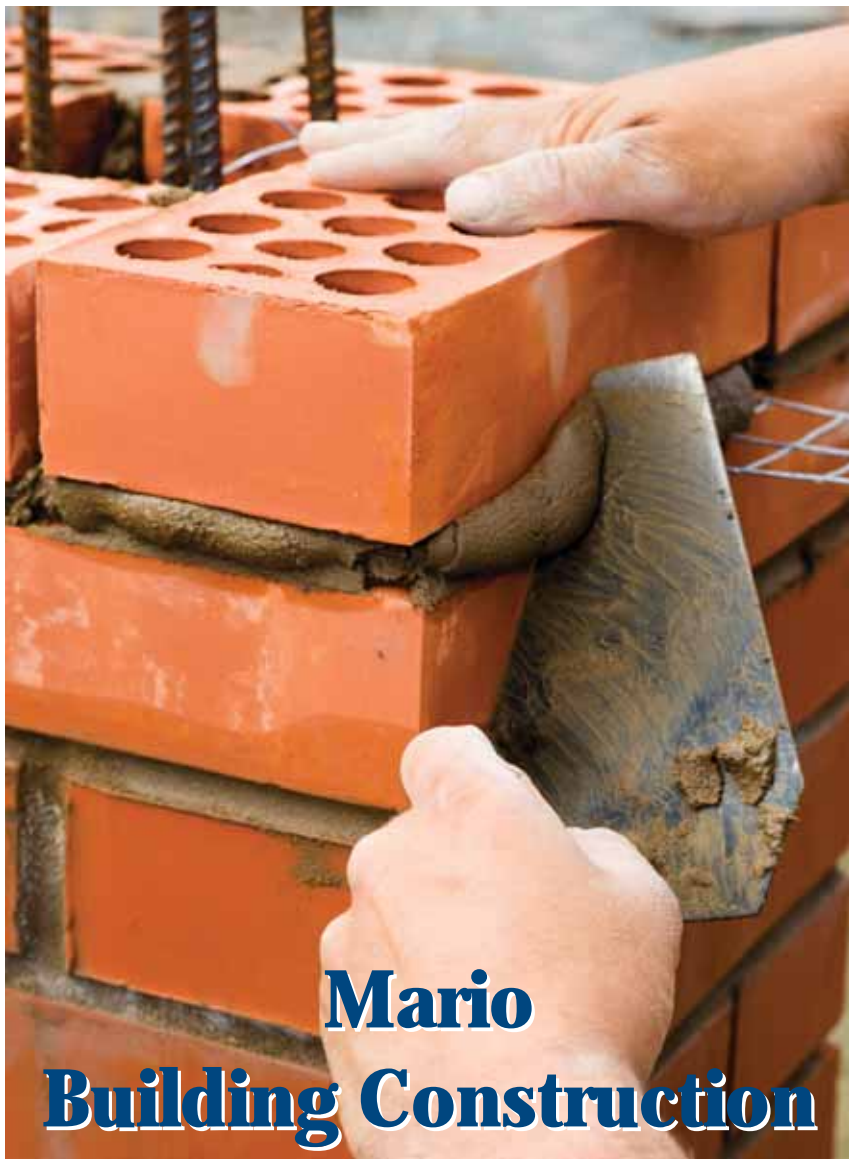

# **Mario Building Construction**

Tel: 01753 523111

Email: [mariobuilding@yahoo.co.uk](mailto:mariobuilding@yahoo.co.uk)

44, Park Lane, Slough, Berkshire SL3 7PF

# Loft Conversions

**Introduction:** most houses have a large space under their roofs normally known as the loft or attic, this space is often underutilised and in some instances can offer an ideal opportunity for expanding your home. This guide has been written to provide you with useful information about how the Building Regulations will affect your loft conversion project.

**Suitability:** not all lofts are suitable for conversion and as a first step it is wise to go into your loft and carry out a brief survey before you get too far into the planning of your project. When carrying out your survey check:

- That there is enough height within your loft to stand comfortably, bearing in mind that your new floor is likely to be around 200mm higher than your existing ceiling joists.
- That there is enough space and headroom for an adequate staircase to be built to access the new loft room.
- That the loft space is large enough to provide a useable room.

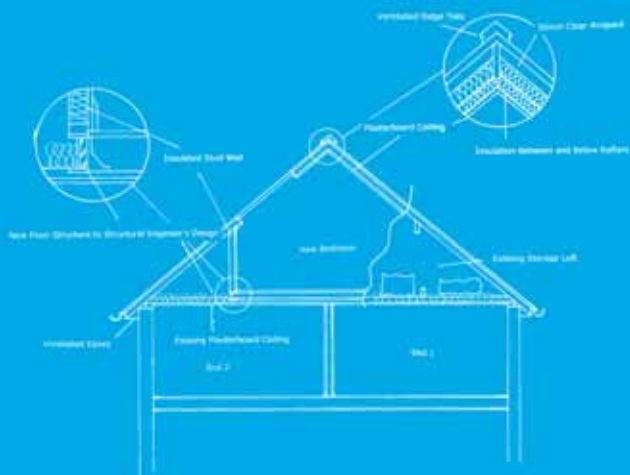

The background of the entire page is a vibrant red. Overlaid on this are several tall, slender buildings rendered as wireframe structures in a glowing orange-red color. The buildings are arranged in a perspective that makes them appear to recede into the distance. The text is white and stands out sharply against the red background.

# Definitive Construction BUILDERS

**07786  
138734**

**[katiekarpinski@btinternet.com](mailto:katiekarpinski@btinternet.com)**

**5 Burns Walk, Thatcham,  
Berkshire RG18 3FU**



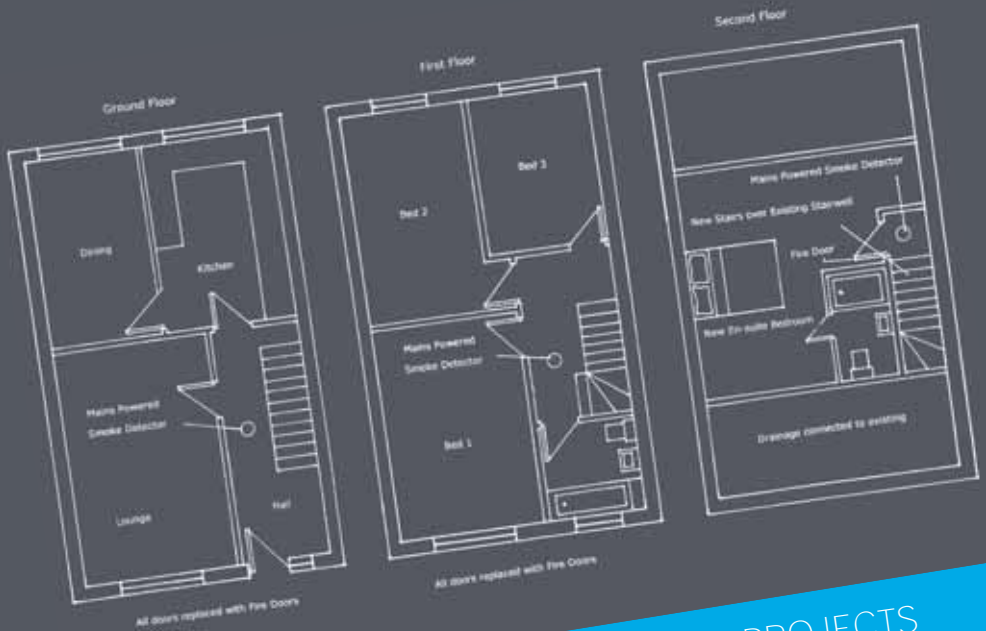

...LOFT CONVERSIONS ARE COMPLEX PROJECTS AND UNLESS YOU ARE EXPERIENCED IN CONSTRUCTION YOU WILL NEED TO GET SOME PROFESSIONAL ADVICE.

- That there aren't any chimneys or services passing through the loft space that will need moving.
- That your roof has felt under the tiles or is fully weathertight.

If the answer to all of these questions is 'Yes' then your loft may well be suitable for conversion.

**How to Proceed:** loft conversions are complex projects and unless you are experienced in construction you will need to get some professional advice. The introduction contained advice about obtaining this and with this in place we can now consider some of the technical issues that affect loft conversions.

## Technical Issues

**The Roof Structure:** the roof of your home is currently designed to keep out the rain and snow and to cope with some light loft storage loading. After a loft conversion your roof will have to cope with significantly different loadings, a new floor structure will be required and it is likely that a number of the structural elements will need to be altered to allow for circulation within the room, roof windows etc. Roofs can generally be divided into two types.

**Trussed Rafter Roofs:** these have been common since the 1970s, and roofs of this type are difficult to convert. Roof trusses are complex pieces of engineering and they should not be altered without the advice of a structural engineer. When converting this type of roof it is common for a series of beams to

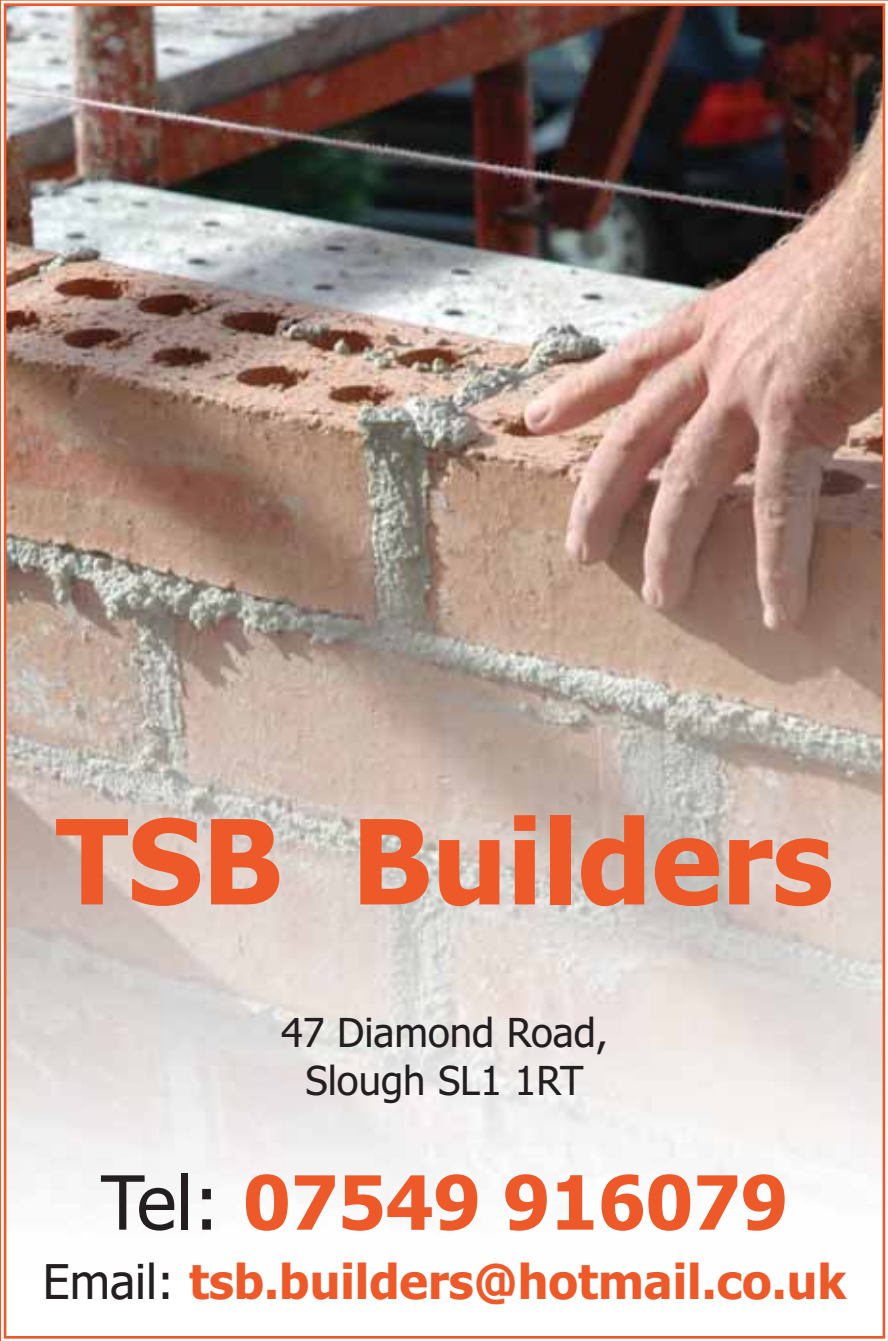

# **TSB Builders**

47 Diamond Road,  
Slough SL1 1RT

**Tel: 07549 916079**

**Email: [tsb.builders@hotmail.co.uk](mailto:tsb.builders@hotmail.co.uk)**

be installed to provide support to the new floor and to strengthen the rafters, this allows the bracing sections of the trusses to be cut out to create a clear floor area.

**Traditional Roofs:** these are generally made up from a series of rafters and purlins spanning between load bearing walls. These roofs are less complicated to convert than Trussed Rafter Roofs, however, beams are often required to provide support to the new floor structure and the existing purlins and a Structural Engineer's design will be required for all but the simplest conversions.

When considering a loft conversion don't be tempted to simply board over your existing ceiling joists and rafters, this can adversely affect the value of your property and in some circumstances can cause overloading and endanger the structural stability of your home.

**Accessing your Loft Conversion:** if you want to convert your loft for habitable use you will need to install a staircase and careful design of this can be critical to the success of your conversion. If there is enough headroom it is often best to continue the stair in the existing stairwell as this saves space and gives a feeling of continuity within the home, alternatively part of a room will have to be partitioned off to accommodate the new staircase. Wherever the stair is installed

it should be designed in accordance with the following guidance.

**Pitch:** the maximum pitch for the stair should not exceed 42 degrees.

**Rise and Going:** the maximum rise of each tread of a domestic stair should not exceed 220mm and the going should be at least 220mm.

**Headroom:** the clear headroom over the stair should be at least 2m, for some loft conversions the Building Regulations allow a reduced headroom of 1.9m over the centre of the stair and 1.8m on the outside edge.

**Handrails and Balustrades:** the stair should be provided with a handrail at least 900mm high and any exposed edges of stairs or landings should be provided with balustrading at least 900mm high.

For loft conversions where space is very limited and only one room is created, a specialist alternating tread staircase can be used, these are steeper than standard stairs and can provide valuable space in some circumstances.

**Fire Precautions:** house fires can kill and fire precautions are a major concern for the Building Regulations. The most dangerous fires generally occur at night when everyone is asleep and to give you awareness of a fire it is important that you install smoke detection. When converting your loft you will need to ensure that you have mains powered, interlinked smoke detectors in the hall/landing areas on every floor of your house.

**Two Storey Houses:** the Building Regulations requirements for fire precautions in two storey housing are quite simple as it is generally felt that if you couldn't get out down the stairs you could jump or be rescued from a first floor window. If you are converting the loft of a bungalow you will need to ensure that you have mains powered interlinked smoke detection at ground and first floor level and that all



## AKORN KITCHENS Ltd

### Storage solutions for any part of your home

With experience we have found that there is an art to making the most of storage space. We can offer a vast array of smart storage solutions, which not only look great, but make your life a whole lot easier. Hiding things away is easy, but being able to allow you to access them, that's the tricky part. With clever design in your new kitchen, bedroom or home study we will help you to maximise every inch of space.

**Akorn Kitchens, 3 The Paddock, Hambridge Road  
Newbury RG14 5TQ**

**Telephone: 01635 49448 • Fax: 01635 49481**

**Email: [info@akornkitchens.co.uk](mailto:info@akornkitchens.co.uk)**

**[www.akornkitchens.co.uk](http://www.akornkitchens.co.uk)**



## K.F & P.K Woods Building Contractors



- ✓ Extensions and alterations including garage conversions
- ✓ Insurance claims
- ✓ Kitchen and bathroom fitting
- ✓ Ceramic wall and floor tiling
- ✓ Plastering, artexing and coving
- ✓ Interior and exterior painting and decorating
- ✓ Laminate flooring
- ✓ Skirting, door frames and architrave replacement
- ✓ All forms of general building
- ✓ Quotes and advice given
- ✓ Fully Insured

Call: 0118 988 7848 (Office)  
07779266349 (Mobile)

[wkfwoods@aol.com](mailto:wkfwoods@aol.com) (Email)

Est. 1973



...A WELL CONVERTED LOFT IS A DEFINITE ASSET TO YOUR HOME, IT CAN PROVIDE USEFUL EXTRA SPACE AND ADD VALUE TO YOUR PROPERTY.

habitable rooms at first floor level have an 'escape window'.

**Escape Windows:** as their name suggests, are windows that are large enough to allow people to escape or be rescued through them. They need to have a clear opening area of at least 0.33m<sup>2</sup> and a clear width of at least 450mm. The bottom of the opening light should be no more than 1100mm above floor level and they should allow people to escape to a place free from danger. Escape windows need to be fitted with escape hinges that allow the window to fully open. Some of the standard hinges fitted to Upvc windows do not achieve this so it is wise to check this with your glazing supplier when you order your windows.

**Three Storey Houses:** when you convert the loft of a house and create a third floor the Building Regulations require you to look at the fire precautions within the house a lot more seriously. Mains operated smoke detection needs to be fitted to give you awareness of a fire and as, due to the height of your new floor, you can no longer rely on escaping through the windows the only safe way out of the house is down the stairs. It is therefore vital that the stair is protected from fire. To protect the stair all of the doors that

open onto the stair need to be fire doors (FD20/E20) and the stair should end up in a hall with a door direct to the outside. Generally, unless a sprinkler system or alternative escape stair is provided, stairs cannot discharge into other rooms in three storey properties.

**Four Storey Houses:** if your house already has three storeys, loft conversions become more complicated. You are likely to need to install a sprinkler system or a second escape stair and the project will need specialist design. Please contact us and we will be happy to provide you with more detailed advice if you are considering one of these projects.

Fire is very dangerous and careful design and planning is required to ensure that the risks it poses are minimised.

**Bathrooms:** it is often a nice idea to include a bath or shower room in your loft conversion, the best place for this is generally directly above your existing bathroom as this should ensure that you can connect into the existing drainage and water supplies without the need for excessive pipework. Any bath or shower rooms will also need to be fitted with an extract fan to improve ventilation. It is a

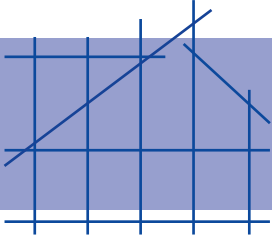

# Williams

Design & Development Ltd

Vision • Planning • Solution

Friendly and professional service providing practical and achievable solutions.

Preparation of plans with submissions to Local Authority for Planning and Building Regulation Approval and Certificate of Lawful Development applications.

House Extensions • Loft & Garage Conversions • New Build • Conservatories & Garden Rooms • Refurbishments & Alterations • Structural Works

- Conceptual Designs
- Design and Build Options
- Lease Compliance Plans
- CAD Drawings Available

**Tel: 01753 831088 Mobile: 07771 662476**

[www.willdesign4u.co.uk](http://www.willdesign4u.co.uk) Email: [info@willdesign4u.co.uk](mailto:info@willdesign4u.co.uk)

# Dawson & Co

*Brickwork Limited*

0118 943 2948

Email: [info@dawsonandco.com](mailto:info@dawsonandco.com)

*20 Kentwood Hill, Tilehurst, Reading RG31 6DE*

good idea to decide on the location of any bathrooms at an early stage in your space planning process.

**Thermal Insulation:** CO<sub>2</sub> emissions are a major concern in today's environment and you will need to provide a high level of insulation to your roof as part of your loft conversion. The most common way of achieving this is to place a high performance insulation board in between and below the rafters. Unless your roof has a breathable felt you will need to leave a void above the insulation and ensure that you have effective roof ventilation to prevent the build up of condensation.

**Sound Insulation:** to reduce unwanted noise the walls and floor around bedrooms will need to be insulated to reduce sound transmission, this is generally achieved by placing 100mm of sound deadening quilt in the floor void and in the partitions around the bedrooms. If you are converting the loft of a semi-detached or terraced property you will need to ensure that the sound resistance of the Party Wall is upgraded so that sound transmission to your neighbours is reduced.

**Heating:** to maximise the usability of the room you will probably want to install heating, in most instances the most effective way of doing this is to extend the existing central heating system. You will need to check with your plumber or heating engineer to ensure that your existing boiler has sufficient capacity to serve any additional radiators and any new radiators should be fitted with thermostatic valves to control the room temperature. If it is not possible to extend the existing system or if you prefer an alternative method of heating, e.g. electric panel heaters, careful consideration should be given as to how these can be switched and controlled to ensure that they function efficiently.

**Electrics:** you are likely to require some electrical alterations as part of your conversion. Depending on the age and

condition of your existing electrical system it is sometimes possible to extend existing circuits but sometimes new circuits and even a new distribution board will be required. It is a good idea to get advice from a competent electrician at an early stage. When appointing an electrician please ensure that they are able to issue you with BS7671 test certificates when they have completed their installation as these will be required before your Building Regulations Completion Certificate can be issued and you will incur additional costs if the test certificates have not been provided.

**Windows and Ventilation:** any new habitable rooms will need to be ventilated. Generally this is achieved by providing an opening window or roof light equivalent to 1/20th of the floor area of the room (depending on angle of opening) with a trickle vent at high level. All new windows must be fitted with highly efficient double glazed units.

In bath or shower rooms an extract fan should be fitted and in rooms without opening windows extract fans should be fitted that are triggered by the light switch with overrun timers that allow the fan to remain on after the light is turned out.

**Conclusion:** a well converted loft is a definite asset to your home, it can provide useful extra space and add value to your property. However a poorly converted loft can reduce your property's value and in some cases compromise your safety and the structural integrity of your home. It is important to ensure that you plan your conversion carefully and get the work carried out by an experienced contractor.

The Building Regulations exist to ensure that buildings are constructed to a reasonable standard; and we will be pleased to provide you with any further assistance that you require during the design and construction of your project.

# JUBILEE BUILDING SUPPLIES LTD



- ✓ Bricks
- ✓ Blocks
- ✓ Plasterboard
- ✓ Plaster
- ✓ Plywood
- ✓ Chipboard
- ✓ M.D.F.
- ✓ Decking
- ✓ Drainage
- ✓ Plumbing
- ✓ Aggregates
- ✓ Ironmongery
- ✓ Moulding
- ✓ Paving
- ✓ Doors
- ✓ Windows
- ✓ Insulation
- ✓ Tools and much more

Flexible Prices,  
Delivery Service  
Open to Trade  
and Public

Tel: 01344 789400

Fax: 01344 789401

Phoenix Business Park, John Nike Way,  
Bracknell, Berkshire RG12 8TN (Opposite Ice Rink)

[www.jubileebuildingsupplies.co.uk](http://www.jubileebuildingsupplies.co.uk)



## Ablerow Building & Roofing

37 Altwood Road,  
Maidenhead, Berkshire SL6 4PB

**Tel/Fax: 0800 1182202**

**Email: [infodave@ablerow.co.uk](mailto:infodave@ablerow.co.uk)**





# Garage Conversions

**Introduction:** if you need more space and you do not want to move house you may wish to consider converting your garage. Your home is probably your most valuable asset so it is important that your conversion project is carefully planned. This guide is not a substitute for professional advice but has been written to provide you with useful information about how the Building Regulations will affect your conversion.

**Suitability:** if you have a brick or block garage attached to your house it is probably suitable for converting. When you are thinking about whether your garage is suitable for conversion you might like to consider:

- Whether there are any known problems with your garage, are there any cracks in it? Is it damp? Does the roof leak? Has the floor been contaminated with fuel or oil?
- How will you get into the new room? Have you got or can you put a doorway through to the garage from the house?
- Will you have enough parking and storage area if you convert your garage?
- Is there enough room in your garage to provide the accommodation that you require or would you be better extending the property?
- Is your existing garage built from an unusual construction? For example, prefabricated panels, concrete frame etc.

If you can resolve all of these issues then your garage may well be suitable for conversion.

**How to Proceed:** garage conversions can be complex projects and unless you are experienced in construction you will need to get some professional advice. The introduction contained advice about obtaining this and with this in place we can now consider some of the technical issues that affect garage conversions.

## Technical Issues

**Infilling the Garage Door Opening:** this tends to be the most visible part of your conversion from the outside and whatever you choose to infill the opening it will need some support. Some garages have a foundation that runs across the garage opening which you can use to support your infill. Unfortunately the only real way to tell if the front of your garage has an

# MORGANMANAGEMENT & MAINTENANCE LTD



Exterior & Interior  
Maintenance and  
Decorating

Telephone: 0794 0099966  
Email: [morganmm@btinternet.com](mailto:morganmm@btinternet.com)  
[www.morganmanagement.co.uk](http://www.morganmanagement.co.uk)

# JSL BUILDERS

– Established 1977 –

Large or small refurbishments

Alterations • Extensions

General Building Maintenance

Telephone: Maidenhead (01628) 623539

Fax: 01628 623539

Email: [david-lang@btconnect.com](mailto:david-lang@btconnect.com)



BEFORE



AFTER

existing foundation is to dig a hole and find out.

If there is no foundation under your garage door opening there are two main options. You can either:

1. Dig a foundation 1m deep or to the same depth as the foundations of the existing garage, call us to inspect the foundation and then fill it with concrete.

Or

2. If the opening is only the width of a single garage door install adequately designed lintels across the opening supported by the existing foundations.

Your Building Control Surveyor will be happy to provide you with more advice about which is the best option for you when we get to site.

With the foundations in place the garage door opening can now be filled in. There are several options for how this can be done. The opening can be filled in with brickwork to match the house and a window. People generally narrow the garage door opening slightly as a full width window can appear out

of proportion. To keep the damp out and to provide insulation it is best to use a cavity wall and your new window should be double-glazed. Other options include installing a lightweight timber framed panel with a weatherproof external surface and insulation, this can be quicker and cheaper and has the advantage that it is easier to remove if you, or any future owners of the house, ever wanted to reinstate your garage. Whichever option you choose it is important that the infill panel provides adequate weather resistance and insulation and that all of the new work is tied into the existing construction. Your Building Control Surveyor will be happy to provide you with advice about this.

**Raising the Floor Level:** garage floors are generally lower than the floor in the main house and they often slope towards the garage door. For these reasons garage floors are generally raised as part of a conversion. There are two main ways of raising a garage floor. Whichever way you choose it is important to consider insulation and damp proofing.



# A.S.B. Blinds

**Tel: 01753 655155**

Specialists In Manufacturing All Types Of Blinds

ASB Blinds Ltd are Specialists In Manufacturing All Types Of Blinds that can look after any size job big or small for commercial or domestic. We have many years' experience in the Blind trade.

We also manufacture our own vertical and roller blinds, and have a vast range of colours and pattern fabrics.

Our showroom at High Street, Iver, Bucks is open  
Monday to Friday 9.30am till 5pm.

[www.asbblinds.com](http://www.asbblinds.com)

## Excel Design Ltd Building Design and Consultancy

Our design, drawing and advice service helps clients plan their project and helps them understand the Local Authority planning process. We always listen to our clients' ideas and help them achieve their dreams and will advise them of any potential problems.

Costs can be difficult to control if problems are not identified at the start. We will advise and endeavour to minimise hidden problems that some builders may not see.

Once we have your proposal drawn on computer it's amazing what can be added and sometimes taken away. It is a process that can make you fully aware of what can and can't be done within your budget. Once you see your floor plan or site plan for example and the space you have, you may well decide that your first ideas can be improved on.

Initially, we would visit your property and offer advice and a fee, this is all free of charge. If you decide to go ahead we would then carry out a detailed survey and prepare your drawings.

Once the drawings are completed, we then offer them to you for acceptance before submitting them to your local authority.

All drawings are of a professional standard and accurately drawn, with all the details that you and your local authority require.

- Detailed measurements
- Sockets and lighting positions for interior design
- Kitchen & bathroom layouts
- Plumbing & heating preferences
- Building specifications
- External & internal features
- Different outline views for discussion

We can get involved as much or as little as you require (but not all this detail is required for Planning and Building Regulation approval).

[www.exceldesign.ltd.uk](http://www.exceldesign.ltd.uk)  
[enquiries@exceldesign.ltd.uk](mailto:enquiries@exceldesign.ltd.uk)  
17 Gorse Ride South, Finchampstead,  
Wokingham, Berkshire RG40 4EH  
Telephone: 0118 973 7336

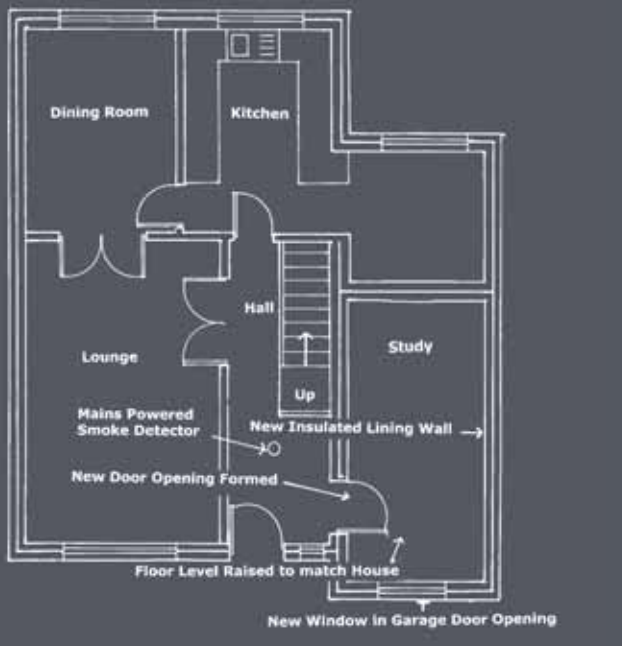

they are often uninsulated. When converting your garage the walls will need to be upgraded.

There are three main areas of concern when upgrading walls in a garage conversion: weather and damp resistance, insulation and sound resistance. The upgrading scheme that you choose will be influenced by the original construction of your garage walls, these can be broadly divided into two categories.

**Cavity Walls:** if your garage is built from cavity walling, weather resistance and damp proofing are unlikely to be a problem. These walls generally have damp proof

courses and providing that your wall is in good condition and is not showing signs of water ingress or rising damp, the wall will simply require insulating and a plaster finish ready for your decoration. There are two options for insulating the wall: either the cavity can be injected with cavity wall insulation or an insulated lining board can be fixed to the inner face of the wall prior to plaster boarding or plastering. Various boards are available and your Building Control Surveyor will be happy to provide advice as to which boards are suitable for your project.

**Solid Brick Walls:** in garages these are generally only a single brick approximately 100mm thick and they often have intermediate piers that buttress the walls and give them additional strength. A single brick wall will not provide adequate weather resistance to a habitable room and a supplementary wall will need to be provided behind the original wall. This can be done either by building an additional skin of

**Option 1:** Concrete: using this method a polythene membrane is placed over the garage floor, floor insulation is laid down, a second polythene membrane is installed and the floor level is brought up to the same level as the house using concrete or sand and cement screed.

**Option 2:** Timber: this method involves placing treated timber floor joists onto a damp proof membrane placed over the existing concrete floor, placing floor insulation between the joists and covering the floor joists with floor boards or tongued and grooved chipboard.

The floor can then be finished with carpet, laminate or any other decorative surface.

**Lining the External Walls:** the walls used to construct garages are not normally up to habitable standards, they are sometimes formed from a single thickness of brickwork and even when built from cavity masonry

**TRADITIONAL  
ROOF TILING &  
SLATING  
CONTRACTORS**



**BUILT UP FELT  
ROOFING  
STRIP &  
RETILE**

## Specification for work

- All new roof
- Old roofing work undertaken
- All new flat roof & repairs
- Re-pointing work
- All types of lead work
- Guttering, fascia & soffit
- Skylight windows installed
- Insurance work undertaken
- No Deposit required
- All work Guaranteed



**For a FREE estimate call: 07766 985 573**

Find out more about us and customer feedback at [www.checkatrade.com](http://www.checkatrade.com)



# DOBSONS



## TIMBER AND BUILDERS MERCHANTS

Largest Selection Of Doors In The Area

### BRICKS - BLOCKS - PAVING - AGGREGATES

All Your Sheet Material Needs

Hardwoods/Plywood/Plasterboard/Veneers/MDF

### SAWN AND PLANED TIMBER

#### Cutting & Machining Service

LOCKS - PAINT - POWER TOOLS - SAND - PLASTER - CEMENT  
GLASS - DOORS - PLUMBING - ELECTRICAL - ROOFING - GUTTERING  
SHEET MATERIAL - STAIRCASE COMPONENTS



## 01753 520978

[sales@dobsonstimber.co.uk](mailto:sales@dobsonstimber.co.uk) / [www.dobsonstimber.co.uk](http://www.dobsonstimber.co.uk)  
104 - 106 Stoke Road, Slough SL2 5AP



masonry to form a cavity wall, the cavity can be insulated as the wall is built, and the wall can then be dry lined or plastered. Alternatively an independent timber framed wall can be constructed with a cavity between the new framing and the existing wall. The frame should be constructed from treated timber and insulation should be provided between the timber studs. Once the frame is in place an insulated plasterboard finish can be applied ready for decoration.

Occasionally garages are built with 225mm thick solid brick walls. If they are in good condition and have a damp proof course they will normally provide adequate weather resistance but they will need to be lined with an insulating board to improve their insulation.

**Party Walls:** if any of the walls of your garage are shared with a neighbour it is considered to be a Party Wall. These walls will need to be upgraded to reduce sound transfer between your new room and your neighbour's property. Your Building Control

Surveyor will be happy to provide you with advice as to how you can upgrade any Party Walls.

**The Ceiling:** unless your existing garage has an adequate ceiling you will need to provide one as part of your conversion. Plasterboard is the most common material used for ceilings as it offers good fire resistance and flame spread properties. Other materials can be used but they will generally need to be treated to improve their fire performance. If the garage is open to a roof you will need to provide insulation above the ceiling and the roof void will generally need to be ventilated above the insulation to reduce the risk of problems with condensation. In a pitched roof fibreglass insulation will normally suffice but with flat roofs, where space is confined, high performance insulation boards are often required. Your Building Control Surveyor will be happy to discuss this with you.

Certain ground conditions will affect the ground floor detail

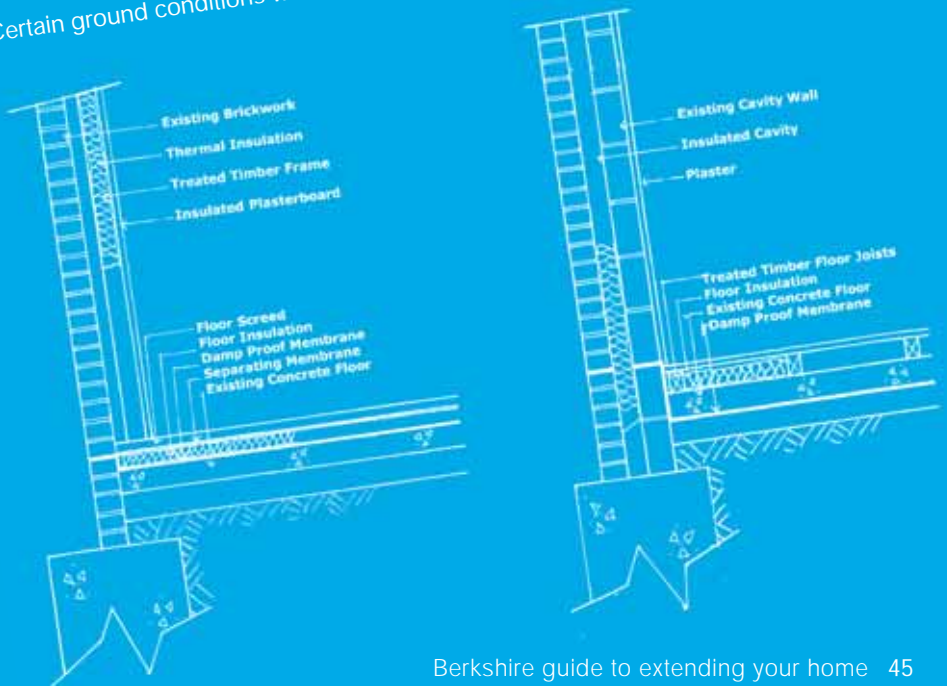

# DURABUILD

- ◆ Federation of Master Builders members for over 20 years and Masterbond registered contractors
- ◆ From design to completion we offer the complete package on extensions, new houses, refurbishment, kitchens, bathrooms and much more
- ◆ We have all the trades in house and are ELECSA registered and FENSA registered and can offer up to a ten year guarantee.
- ◆ The knowledge we have gained in over 30 years (established 1979) experience means we can cover all aspects of work you may require
- ◆ We currently work for many housing associations, schools, hotels and private companies in Berkshire
- ◆ All customers will receive an honest and personal service at affordable prices – we can help you today.



Unit 2, Hyperion Way, Reading, Berkshire RG2 0HG  
Telephone: 0118 923 9930

**Inspirational***designs*  
BUILDING CONTRACTORS

Building Beyond Expectations



Office: 01344 624067 Mobile: 07802 980098  
[www.idbc.co.uk](http://www.idbc.co.uk) [mark.hanson@idbc.co.uk](mailto:mark.hanson@idbc.co.uk)





**Heating:** to maximise the usability of the room you will probably want to install heating; in most instances the most effective way of doing this is to extend the existing central heating system. You will need to check with your plumber or heating engineer to ensure that your existing boiler has sufficient capacity to serve any additional radiators and any new radiators should be fitted with thermostatic valves to control the room temperature. If it is not possible to extend the existing system, or, if you prefer an alternative method of heating, e.g. electric panel heaters, careful consideration should be given as to how these can be switched and controlled to ensure that they function efficiently.

**Drainage:** if you are looking to include a sink, bathroom, shower room or cloakroom in your conversion it is important that you consider drainage at an early stage. Any new appliances will need to connect to your existing foul drainage system as they are not allowed to be connected into rainwater drains. When planning your layouts make sure that there are suitable routes for pipes to run to a point where they can connect to existing drains.

**Windows and Ventilation:** any new habitable rooms will need to be ventilated. Generally this is achieved by providing an opening window equivalent to 1/20th of the floor area of the room with a trickle vent at high level. All new windows must be fitted with highly efficient double glazed units and it is wise to make sure that they contain an opener with a clear area of at least 0.33m<sup>2</sup> and 450mm wide which should be large enough for you to escape through in the case of fire. This is essential if the door out of your garage opens into a room other than your entrance hall. Special fire escape hinges should be fitted to this window to ensure that it can be fully opened if you ever need it. In bath or shower rooms an extract fan should be fitted and in rooms without opening windows extract fans should be

fitted that are triggered by the light switch with overrun timers that allow the fan to remain on after the light is turned out.

**Fire Precautions:** when you are investing money in your home it is a good opportunity to review the fire precautions that are available in the existing house. Mains operated smoke detection significantly improves fire safety in the home and the Building Regulations require that it should be installed where garages are converted to habitable rooms.

**Electrics:** you are likely to require some electrical alterations as part of your conversion. Depending on the age and condition of your existing electrical system it is sometimes possible to extend existing circuits but sometimes new circuits and even a new distribution board will be required. It is a good idea to get advice from a competent electrician at an early stage. When appointing an electrician please ensure that they are able to issue you with BS7671 test certificates when they have completed their installation as these will be required before your Building Regulations Completion Certificate can be issued and you will incur additional costs if the test certificates have not been provided.

**Conclusion:** a well designed and constructed garage conversion can be a definite asset to your home that can provide useful extra space and add value to your property. A poorly thought-out conversion can reduce your property's value and in some cases compromise your safety and the structural integrity of your home. It is important to ensure that you plan your conversion carefully and get the work carried out by an experienced contractor.

The Building Regulations exist to ensure that buildings are constructed to a reasonable standard; your local Berkshire Building Control Authority will be pleased to provide you with any further assistance that you require during the design and construction of your project.

**SERVICES:**

- Survey Drawings
- Planning Applications
- Building Control
- Shopfront Visuals
- Interior Design
- Technical Drawing
- Furniture Design
- Interior Visualising
- Shopfitting
- Project Management

**DESIGN FOR SALON & COMMERCIAL INTERIORS**

[www.yydesign.co.uk](http://www.yydesign.co.uk)  
[info@yydesign.co.uk](mailto:info@yydesign.co.uk)

Unit 2-3 Mirage Centre, First Way  
 Wembley, Middlesex, HA9 0JD  
 Tel: 020 8902 0719

**YY DESIGN**

# Need More Space?

Concerned about the housing market?  
 Want to add value to your property?  
 Tired of your old kitchen or bathroom?

**Why not extend or improve your property?**  
**NO MOVING COSTS • NO STAMP DUTY • NO AGENTS FEES**

Home Extensions • Garage Conversions • Conservatories  
 Kitchen & Bathroom Fitting • Loft Conversions  
 Outside Improvements with Paving and Patios

## CLD Construction Ltd

is a well established, local building company with extensive experience in all types of construction from new builds to patios. The highest references and examples of work are available, particularly in your area. A full building service is available from the initial planning stage through to the final decorations and landscaping.

For an initial consultation please contact Charles Dixon.

**Tel/Fax: 01635 255140 Mobile: 07831 466710**  
**Email: Charles4cdcon@aol.com**



# Domestic Cellar Conversions

**Introduction:** if you are fortunate enough to have a cellar beneath your house and you need more space you may wish to consider converting your cellar. Your home is probably your most valuable asset so it is important that your conversion project is carefully planned. This guide is not a substitute for professional advice but has been written to provide you with useful information about how the Building Regulations will affect your conversion.

**Suitability:** if you have a cellar beneath your house it may well be suitable for converting. When you are thinking about whether your cellar is suitable for conversion you might like to consider:

- Is there sufficient headroom in the cellar, bearing in mind that the ceiling and the floor treatments that you will have to install are likely to reduce the available headroom?
- Does the cellar ever flood?
- What is the access like? Is there a place for a staircase?
- Will you have enough storage area if you convert your cellar?



# RSP BUILDERS

**DESIGN & BUILD – GENERAL BUILDING**

QUALITY BUILDER - 35 YEARS EXPERIENCE

SPECIALISING IN EXTENSIONS,  
RENOVATIONS, REFURBISHMENT

TESTIMONIALS AVAILABLE ON REQUEST

**Tel/Fax: 0118 942 1847 • Mobile: 07956 913396**

**Email: [r\\_pink@hotmail.co.uk](mailto:r_pink@hotmail.co.uk)**

**Mallard House, 2 Oak Tree Walk, Purley-on-Thames, Reading, Berkshire RG8 8BN**

GST maintenance is a small, family run, electrical company who are able to provide the home owner with a friendly & reliable service. We are registered with the NICEIC part P domestic installer scheme & can undertake any domestic electrical work.

## *GST MAINTENANCE*

electrical services



32 Roman Way  
Thatcham, Berkshire, RG18 3BP

Tel: 01635 871866 Mobile: 07789 864079 Email: [admin@gstmaintenance.uktc.com](mailto:admin@gstmaintenance.uktc.com)

**[www.gstmaintenance.uktc.com](http://www.gstmaintenance.uktc.com)**

GST maintenance are a NICEIC part P approved & 17th edition compliant company

- Is there enough room in your cellar to provide the accommodation that you require or would you be better extending the property?
- Is there any ventilation to your cellar or could any be provided?

If you can resolve all of these issues then your cellar may well be suitable for conversion.

**How to Proceed:** Cellar conversions can be complex projects and unless you are experienced in construction you will need to get some professional advice. The introduction contained advice about obtaining this and with this in place we can now consider some of the technical issues that affect cellar conversions.

## Technical Issues

### Lowering the Cellar Floor:

If there is not sufficient headroom in your cellar it is sometimes possible to lower the cellar floor. This is not however a simple operation and careful consideration needs to be given to whether lowering the floor will undermine the house or the neighbour's house foundations and whether the floor will end up below the water table and make the property more vulnerable to flooding. Specialist advice should always be taken before considering lowering cellar floors.

**Waterproofing:** as most cellars are set within the ground they tend to suffer from problems with damp. If it is to be converted to a habitable room your cellar will need to be damp proofed. A number of systems are available for damp proofing cellars and most of them use a proprietary waterproof render system known as tanking. This is applied so that it forms a continuous damp proof layer across the floor and up the walls and is generally installed by specialist companies who will offer an insurance backed guarantee for the installation. Protecting your cellar from damp is an important part of the cellar conversion process and we will need

to approve details of the system that you are using and the installer prior to installation.

**Access:** some cellars already have good stepped access to them, whether the existing stairs will provide suitable access to a habitable room is a matter of judgment and our Building Control Surveyors will be happy to offer advice. If there are no steps, or if the existing steps are inadequate, a new stair will need to be installed. Careful consideration should be given to the best location for the stair and this will be influenced by a number of factors including the layout of the existing house and cellar, the headroom available and whether a secondary means of escape can be provided from the cellar area. Wherever the stair is installed it should be designed in accordance with the following guidance.

**Pitch:** the maximum pitch for the stair should not exceed 42 degrees.

**Rise and Going:** the maximum rise of each tread of a domestic stair should not exceed 220mm and the going should be at least 220mm.

**Headroom:** the clear headroom over the stair should be at least 2m, for some loft conversions the Building Regulations allow a reduced headroom of 1.9m over the centre of the stair and 1.8m on the outside edge.

**Handrails and Balustrades:** the stair should be provided with a handrail at least 900mm high and any exposed edges of stairs or landings should be provided with balustrading at least 900mm high.

**Fire Precautions:** your cellar will need to be provided with suitable escape routes in case of a fire. If your cellar has a light well it may be possible to upgrade this so that as well as providing ventilation to the room it can provide a secondary fire escape. To be considered as a secondary fire escape it would need to be fitted with a door or window with a clear area of at least 0.33m<sup>2</sup> and 450mm wide. Special fire escape hinges should be fitted to this window to ensure that it can be fully opened if you ever



## S&S Roofing CONTRACTORS



Tel: 0118 948 1807  
Mobile: 07710 989 547  
[www.ssroofing.co.uk](http://www.ssroofing.co.uk)  
Email: [info@rooferberkshire.co.uk](mailto:info@rooferberkshire.co.uk)  
276 Kidmore Road, Caversham,  
Reading, Berkshire RG4 7NF

S&S Roofing Contractors is a roofing company based in Reading operating throughout the surrounding area. We cover all aspects of roofing including flat roofing, lead work, tiles, slates, guttering, water proofing and maintenance.

We serve a wide range of domestic and commercial clients with a prompt, reliable and professional service at very competitive rates.

Below you will find a complete list of all of the services we offer, if the service you require is not listed here but you feel we can help please do not hesitate to get in touch and a member of our team will be delighted to help you.

- Flat Roofing • Felt Roofing • Re-Roofing
- Lead Work • Guttering • Tiling & Slating • Water Proofing
- Roof Maintenance

## Architectural Design

- **Planning Advice**
- **Listed Buildings Applications**
- **Residential and Commercial projects**
- **New Houses, Flats and Offices**
- **Planning Applications**
- **Building Regulations Applications**
- **Extensions, Alterations and Conversions**
- **Free initial consultation**

Stratton Design  
Crowthorne Enterprise Centre  
Old Wokingham Road  
Crowthorne RG45 6AW

**01344 753360**  
**[www.strattondesignservices.co.uk](http://www.strattondesignservices.co.uk)**



...A WELL CONVERTED CELLAR CAN BE AN INTERESTING SPACE AND CAN BE A GREAT WAY OF GETTING EXTRA ROOM IN YOUR HOUSE.

need it and you should be able to easily climb up from the light well to ground level. If you cannot provide a secondary fire escape the staircase will need to end up in a fire protected hallway with a door direct to outside.

When converting your cellar it is a good opportunity to review the fire precautions that are available in the existing house. Mains operated smoke detection significantly improves fire safety in the home and the Building Regulations require that it should be installed where cellars are converted to habitable rooms.

**Drainage:** if you are looking to include a sink, bathroom, shower room or even a washing machine in your conversion it is important that you consider drainage at an early stage. Any new appliances will need to connect to your existing foul drainage system and the drains are usually above the

level of the appliances that you wish to install. You are likely to need to install a pumped drainage system and various package systems are available that macerate the drainage and pump it via a small diameter pipe to the existing drainage system. When planning your layouts make sure that there are suitable routes for pipes to run to a point where they can connect to existing drains.

**The Ceiling:** unless your existing cellar has an adequate ceiling you will need to provide one as part of your conversion. Plasterboard is the most common material used for ceilings as it offers good fire resistance and flame spread properties. Other materials can be used but they will generally need to be treated to improve their fire performance. If either your cellar or the room above is to be used as a bedroom you will need to install 100mm of acoustic quilt within the floor void between the rooms.

# Day & Knight

## Bedroom Design & Fitting



Creating the bedroom of your dreams

*We offer free design and quotation with no obligation to purchase. We have over 30 door styles to choose from, in traditional, classic or contemporary styles. All of our furniture is fitted wall to wall and floor to ceiling to maximise the use of all available space.*



Telephone: 01753 681495 • Mobile: 07979 424738  
www.day-and-knight.co.uk • email: jonathan@day-and-knight.co.uk

## Comprehensive Commercial & Domestic Builders



# FOWLES

developments

New Builds  
Extensions  
Refurbishments  
Loft Conversions  
Redesign of Living Space  
Office Refurbishment & Relocation

Tel: (0118) 9666616 / 9668642



www.fowlesdevelopments.co.uk





**Heating:** to maximise the usability of the room you will probably want to install heating, in most instances the most effective way of doing this is to extend the existing central heating system. You will need to check with your plumber or heating engineer to ensure that your existing boiler and pump has sufficient capacity to serve any additional radiators. Any new radiators should be fitted with thermostatic valves to control the room temperature. If it is not possible to extend the existing system, or, if you prefer an alternative method of heating, e.g. electric panel heaters, careful consideration should be given as to how these can be switched and controlled to ensure that they function efficiently.

**Ventilation:** any new habitable rooms will need to be ventilated and this can sometimes present a problem for cellar conversions. Where the cellar contains a light well this can sometimes be adapted to include an opening window equivalent to 1/20th of the floor area of the room (depending on angle of opening) with a trickle vent at high level. In any bath or shower rooms an extract fan should be fitted and if they do not have opening windows extract fans should be fitted that are triggered by the light switch with overrun timers that allow the fan to remain on after the light is turned out. Where natural ventilation through windows is not practical a mechanical ventilation system will need to be installed and various package systems are available on the market. Ventilation should be considered early in the design stage as, if mechanical ventilation is required, the duct work will need to be accommodated.

**Thermal Insulation:** CO<sub>2</sub> emissions are a major concern in today's environment and you will need to provide a high level of insulation within your conversion. Your cellar should provide an insulated envelope so that the amount of heat escaping is minimised.

The walls and floor of your cellar are generally lined with insulating boards. As well as insulating your extension you will need to consider the efficiency of any services you put into it. Low energy light fittings should be used where possible and any new heating systems should work to high levels of efficiency and have suitable thermostats and controls.

**Electrics:** you are likely to require some electrical alterations as part of your conversion. Depending on the age and condition of your existing electrical system it is sometimes possible to extend existing circuits but sometimes new circuits and even a new distribution board will be required. It is a good idea to get advice from a competent electrician at an early stage. When appointing an electrician please ensure that they are able to issue you with BS7671 test certificates when they have completed their installation as these will be required before your Building Regulations Completion Certificate can be issued and you will incur additional costs if the test certificates have not been provided.

**Conclusion:** a well converted cellar can be an interesting space and can be a great way of getting extra room in your house. Cellar conversions are often not simple projects and a poorly thought-out conversion can reduce your property's value and in some cases compromise your safety and the structural integrity of your home. It is important to ensure that you plan your conversion carefully and get the work carried out by an experienced contractor.

The Building Regulations exist to ensure that buildings are constructed to a reasonable standard; your local Berkshire Building Control Authority will be pleased to provide you with any further assistance that you require during the design and construction of your project.

## Life Cycle Building Services Ltd



**Let your building live**

We are a family owned company proudly serving Berkshire and the surrounding areas. As ex-military personnel we ensure our work and service is to the highest standard in order to give 100% customer satisfaction and maintain our proud reputation.

We offer FREE quotations on all services both commercial and domestic.



[www.lifecyclebuildingservices.co.uk](http://www.lifecyclebuildingservices.co.uk)

Tel Free: 0800 292 2540

Email:

[enquiries@lifecyclebuildingservices.co.uk](mailto:enquiries@lifecyclebuildingservices.co.uk)

Life Cycle Building Services Ltd.  
6 Bucknell Court, The Old Lane, Reading RG1 6FB

## No.1 Ace Construction Ltd

Some of what no1 ace construction undertake:



Roofing	Extensions
Driveways	Tarmac
Bricklaying	Windows & Doors
Pathways	Patios
Plastering	Drainage
Drop kerbs	Refurbishment

Mobile Number: 07549001094

Freephone: 0800 468 1223

[www.no1aceconstructionltd.piczo.com](http://www.no1aceconstructionltd.piczo.com)

Email: [markdimmick@hotmail.co.uk](mailto:markdimmick@hotmail.co.uk)

## C&D

### Energy Assessments

Local Domestic Energy Assessor

Multiple EPC Discount

Energy Performance Certificate

Domestic Sale & Rental EPCs

Fully Accredited & Insured

Fast Reliable Service

Tel: 07748 153250

[Trevor@candea.co.uk](mailto:Trevor@candea.co.uk)

Fernbank, Court Lane, Burnham, Slough,  
Berkshire SL1 8DN



## C. Sawyer

Building Contractors

- New Extensions
- Alterations and Conversions
- Barn Conversions
- Been Trading for 25 years
- Can Provide Portfolio of names and addresses of previous Clients
- All work to high standard

[www.c-sawyer-builders.com](http://www.c-sawyer-builders.com)

Email: [csawyer@ukbuilder.com](mailto:csawyer@ukbuilder.com)

Tel: 01189 692021 • Mob: 07768533774

7 Glebe Lane, Sonning On Thames, RG4 6XN



# Other Alterations

**Introduction:** a number of home improvement projects are covered by the Building Regulations and this chapter sets out to explain how the Building Regulations affect some of the projects that you may be considering.

This guide is not a substitute for professional advice but has been written to provide you with useful information about how the Building Regulations will affect your project.

## Removing Internal Walls

Internal walls have a number of functions, some are fundamental to the structure of the house, some offer fire protection to the stairway and others merely divide up the space within the house and can be altered or removed with very few issues.

Load bearing walls are fundamental to the structure of the house and careful consideration needs to be given before they can be altered or removed. Alteration or removal of load bearing walls requires Building Regulations consent and generally speaking a structural engineer should be commissioned to design the alteration.



## D2B designs

Design and prepare architectural drawings for extensions, loft and garage conversions, alterations and improvements to your home.

We also carry out custom designs for new homes and developments with your needs in mind.

All plans are prepared and submitted on your behalf for Local Authority Building Control and Planning Approvals.

For a prompt, private and professional service call 07973 621078 or e-mail [gabd@d2bdesigns.co.uk](mailto:gabd@d2bdesigns.co.uk) and speak to Graham for a free quote and friendly, helpful advice.

## LEWINGTON & SON

DOMESTIC & TRADE  
SUPPLIERS AND INSTALLERS

- ALUMINIUM & UPVC WINDOWS
- CONSERVATORIES • DOORS
- UPVC FASCIAS & SOFFITS
- CUTTERING
- GARAGE DOORS
- REPAIRS



**FENSA**  
Registered Company

Tel: 0118 957 3032

Fax: 0118 939 3708

Web: [www.lewingtonandson.co.uk](http://www.lewingtonandson.co.uk)

## ENVY

Garden Design

Envy Garden Design is an RHS gold medal winning company that offers a professional and personal garden and landscape design service for both individuals and developers alike.

Give us a call on 01344 482800 to see how Envy can help your garden or visit [www.envygardendesign.co.uk](http://www.envygardendesign.co.uk)

## SP Plumbing

*Bathroom Planners  
& Furnishers*



01628 630161

62 Thurlby Way, Maidenhead SL6 3YZ

LOAD BEARING WALLS ARE FUNDAMENTAL TO THE STRUCTURE OF THE HOUSE AND CAREFUL CONSIDERATION NEEDS TO BE GIVEN BEFORE THEY CAN BE ALTERED OR REMOVED.

The structural engineer will consider what loads the wall is taking and will design a beam and, if necessary, other supporting structure to ensure that the loads the wall was carrying are safely transmitted to the ground. We will then inspect the work as it progresses and then issue a completion certificate to show that the work complied with the Building Regulations.

The walls around your staircase offer you some protection to allow you to escape if your house catches fire and the alteration of these walls requires Building Regulations consent. If these walls are removed it is essential that your house is fitted with mains operated smoke detection and that all of

your rooms have windows suitable for fire escape purposes (see Fire Precautions – Domestic Extensions). If you wish to remove one of these walls contact us and we will arrange to visit you to establish whether the walls are essential to the fire protection within your house and advise what, if any, additional work is required to allow the alterations to take place.

### Bay Windows and Chimneys

In Building Regulations terms these are basically small extensions. They require Building Regulations consent and much of the guidance in the Extensions chapter is relevant albeit on a somewhat smaller scale. Chimneys require lining with a flue liner that

# Bedmar Construction

*Kitchens Fully Fitted  
Kitchens, Worktops & Sinks  
All Heating & Plumbing  
Full Plan & Design Service  
Contemporary  
& Traditional  
Fully Guaranteed  
& Insured*



**01189 794250**

Email: [bedmar2003@msn.com](mailto:bedmar2003@msn.com)  
40C, Easthampstead Road, Wokingham,  
Berkshire RG40 2EG



# fusion

fusion electrical maidenhead Ltd



7 Cannon Court Road  
Maidenhead, Berkshire SL6 7OS

**Tel: 01628 623331**  
**Mob: 079195 77757**

[fusion@berks.uk.net](mailto:fusion@berks.uk.net)

# Thames Valley Scaffolding

**SCAFFOLDING HIRE,  
SUPPLY & ERECT**

**Industrial, Commercial & Domestic  
Short Term/Contract  
£10 mill. Public Liability**

**Ring For Free Survey & Estimates**

**01189 428 011**

**Mob. 07747 020529**  
**4 Manor Park Close, Tilehurst,  
Reading, Berkshire RG30 4PS**

**K.D.JONES**  
Roofing & Building Services



- Roofing Services • Slating Services
- Guttering • Flat Roofs
- Lead Work • & More

*We have developed an exceptional  
reputation for excellent services*

Give us a call today for a **FREE**,  
no obligation quotation.

[www.roofer-bracknell.co.uk](http://www.roofer-bracknell.co.uk)

**Tel: 01344 886 944**

**Mobile: 07973 693738**

5 Woolford Close Bracknell Berkshire RG42 7PR

is suitable for the fire that they will serve and the installer should test the flue prior to commissioning the fire.

We will carry out a series of inspections on these projects and issue a completion certificate when the works are satisfactorily completed.

### New Drainage

Replacement kitchens and bathrooms do not generally need Building Regulations consent but where new drainage is installed to serve a new bathroom or other appliance Building Regulations consent is required. With these projects we will carry out a series of inspections to ensure that the drainage and ventilation is satisfactory and issue a completion certificate when the works are satisfactorily completed.

### Replacement Boilers and Alterations to Electrical Systems

These alterations require Building Regulations consent although in practice most of this work is carried out by

contractors who can self certify their work. Details of the self certification scheme are given in the introduction to this guide and, if your contractor is able to self certify, you will not need to make a separate Building Regulations application.

If you wish to use a contractor who is not registered with a self certification scheme please contact us and we will arrange for the necessary application to be submitted, carry out the relevant inspections and issue your completion certificate when work has been satisfactorily completed.

Whichever scheme you use make sure that you get the completion certificate as you will need this if you wish to sell your house.

### Conclusion

This guide has endeavoured to provide useful information about a range of typical domestic projects and we hope that you have found it useful. If you need any further information about a project that you are considering please contact us and we will be happy to provide further advice.

## Diamond Driveways

Diamond Driveways commit to providing their customers with an exceptional level of customer service and provide good quality work at affordable prices. Here at Diamond Driveways we tailor driveways to your needs and budget and are able to provide friendly professional advice.

We also can build ornamental walls, install flower beds, fencing including decorative fencing, decking, concrete bases, tarmac. We also install concrete driveways including imprinted concrete and Stencil-Tek.



BEFORE



AFTER

[www.checkatrade.com/DiamondDriveways](http://www.checkatrade.com/DiamondDriveways)  
telephone: 01189 712175  
mobile: 07778 553740  
email: [phillipperry1@hotmail.co.uk](mailto:phillipperry1@hotmail.co.uk)  
Rag Hill, Aldermaston, Reading, Berkshire, RG7 4NU



Registered installers of  
Swish & Freefoam

**FASCIAS • SOFFITS • GUTTERS • CLADDING**

Family business established 1985

All work undertaken by us

No sub-contractors

No pressure salesmen

No deposit required

Payment only on full satisfaction

20 year guarantee

Contact John for a FREE quotation:

**0118 986 2974**

[www.johnyoungandson.co.uk](http://www.johnyoungandson.co.uk)

## 1st Choice D.B. Driveways Ltd

61 Allenby Road, Maidenhead, SL6 5BG

- Drives & Paths
- Drop Kerbs
- Block Paving
- Shingle

*Quick, clean & efficient*  
**£5 million liability insurance**  
**Free Estimates**

e-mail [rebeccabarney31224@btinternet.com](mailto:rebeccabarney31224@btinternet.com)

Tel: 01628 675965/825596

Mob: 07850 433591

## Heating by Degrees

Boilers & Bathrooms



Heating by Degrees does just two things:

1. The design, supply, installation, maintenance and the servicing of gas central heating systems,
2. The design, supply and installation of bathrooms, shower rooms, cloakrooms, etc.

Whatever we do, we have two simple aims – to provide an excellent service and good value to our customers.

Tel: **0118 932 1081** Mob: **07767 796100**

E-mail: [guy@heatingbydegrees.com](mailto:guy@heatingbydegrees.com)  
[www.heatingbydegrees.com](http://www.heatingbydegrees.com)

Heating by Degrees Ltd  
PO Box 4703, Earley, Reading RG5 4GT





# Radon

**Radon:** Radon is a natural radioactive gas. You cannot see, smell, hear or feel it. It comes from minute amounts of uranium that occur naturally in all rocks and soils and the air in all buildings contains a degree of radon.

The gas can move through cracks and fissures in the subsoil and eventually to the atmosphere. Most of the radon will disperse harmlessly but some will pass from the ground and collect in spaces under or within buildings.

Some areas of the country might have unacceptably high concentrations unless precautions are taken; the granite areas of South-West England is one of these areas.

The level of radon protection required to your extension depends on the location of your property. This can be determined either by consulting your local Berkshire Building Control Authority or by accessing the maps on the Building Research Establishment website. The maps indicate the highest radon potential within each 1-km grid and determines whether full or basic radon precautions are required or if radon protection is not needed at all. More accurate information is available from the Health Protection Agency or the British Geological Survey.

Radon protective measures can be included relatively easily and cost-effectively within extensions to dwellings.

All extensions to dwellings which fall within a full or basic radon protection area will be required to incorporate an appropriate level of radon protection if a new ground floor is provided.

**Full radon protection:** The damp proof membrane (minimum 1200g) acts as the radon barrier. It is important that the membrane extends through the cavity and is linked with a cavity tray. A subfloor sump is also required. Where the existing house has a solid floor the sump could be used to reduce the level of radon in both the extension and the existing building.

**Basic radon protection:** Only the continuous damp proof membrane is required.

The detailing in both cases will depend on the type of construction used and the positioning of the damp proof membrane, your local surveyor will be able to give you further guidance, alternatively examples are provided on the BRE website.

# AH Roofing And Building Services

46 Home Farm Close,  
Reading,  
Berkshire  
RG2 7TD

**07810 044256**

ahroofingandbuildingservices@yahoo.co.uk

Richard Tweedale Bsc Arch Dip Arch

*Architecture, Design and Planning.*

Creative design solutions  
for residential extensions, new builds  
and refurbishments in contemporary  
and traditional styles

Planning and Permitted  
Development Applications

Building Regulations Applications  
and Working Drawings

Tender and Contract procedures

Contract administration during work  
on site

*Telephone or email  
to arrange a free consultation*

**01628 523652**

**07774 531549**

Email: richard.tweedale@btinternet.com

The Studio, Bradcutts, Alleyns Lane, Cookham,  
Berks SL6 9AD



**M D Howlett Associates Ltd**  
architectural consultant

Over twenty years experience in  
all aspects of domestic and  
commercial architecture, including  
designs, local authority applications  
and contract administration.

Second Floor  
23 Prospect Street  
Caversham  
Reading  
Berkshire RG4 8JB

Tel/Fax: (0118) 947 7117  
Email: pmaarc@globalnet.co.uk

**Martin Butler  
Partnership Limited**

*Architectural Design  
& Planning Consultants*

Local Authority, Approvals for  
New Build, Extensions,  
Refurbishments & Space Planning

28 Broad Street, Wokingham,  
Berkshire RG40 1AB  
Tel / Fax: 0118 989 0990  
Email: mbpltd@btopenworld.com

Wherever possible the construction joint between the new floor and the existing house should be sealed. Where radon barriers have been incorporated in both the new floor and the existing floor, the aim should be to joint the two barriers where they meet within the wall of the house. This is difficult to achieve in practice without damaging the existing barrier and a simpler alternative is to cut a chase in the wall slightly above or below the existing barrier in which to tuck the new barrier.

If the existing house has a beam and block or suspended timber floor, care should be taken to ensure that the provision of sub-floor ventilation is maintained.

It is recommended that you have your house measured for radon before plans are prepared. Ideally measurement should be over at least 3 months; the Health Protection Agency (HPA) can provide detectors for this purpose. If your dwelling is found to exceed the current recommended action level, appropriate protection measures can be incorporated into your building project.

### Landfill Sites

Where you are developing adjacent to landfill sites, landfill gas protection measures will be required and the approach will be similar to Radon. Please therefore contact your Building control Surveyor for further guidance where there are possible landfill gas issues.

Figure 1 Routes by which radon enters a dwelling



#### Key to ingress routes

- 1 Through cracks in solid floors
- 2 Through construction joints
- 3 Through cracks in walls below ground level
- 4 Through gaps in suspended floors
- 5 Through cracks in walls
- 6 Through gaps around service pipes
- 7 Through cavities in walls

### Useful contacts

#### HPA – Radon Studies Group

Radiation Protection Division  
Health Protection Agency  
Chilton, Didcot  
Oxon OX11 0RQ

[www.ukradon.org](http://www.ukradon.org)

#### Building Research Establishment

Garston  
Watford WD25 9XX

[www.bre.co.uk/radon](http://www.bre.co.uk/radon)

#### British Geological Survey

Keyworth  
Nottingham, NG12 5GG

[www.bgs.ac.uk/radon](http://www.bgs.ac.uk/radon)

**ATTENTION**

## EXTENDING YOUR HOME?



You will need an energy assessment to show compliance to building regs.

We can provide the following for your extension project:

- Free Planning Advice
- LED Lighting Design
- Code For Sustainable Homes
- EPCs / SAP Energy Assessments
- Part L Compliance Reports
- Energy Strategy Reports & Energy Audits
- Building Services Design Consultancy
- Daylighting Calculation Reports
- Renewable Design  
(PV, Solar Thermal, Heat Pumps)



6 Warren House, 1757 St Peters Avenue, Reading, RG4 7RW  
Telephone: +44 (0)8450 091625 Email: [mail@syntegra-epc.co.uk](mailto:mail@syntegra-epc.co.uk)

[www.syntegraconsulting.co.uk](http://www.syntegraconsulting.co.uk)





# Mining

Britain's industrial history creates problems for developers in relation to ground stability, foundation design and contaminated land.

There are areas within England and Wales that have historically been heavily mined – particularly in the West, East and North – but also in the Reading area we have had chalk mining operations. Therefore, particularly in these identified 'hot spots', specialist investigations are required to assess the risks associated with building on land that is affected by a history of mining.

For new buildings and areas of concern, initially a desk study is required to assess the risk to the development. A desk study is carried out by a suitably qualified person and investigates the possible risks associated with mining using maps and archive records. This report will then provide recommendations and a conclusion. The recommendations will normally say either that there is minimal risk from mining activity or that further investigations are necessary.

If further investigations are required this will involve site investigations. Depending on the nature of the ground the investigations can range from the inspection of the foundation trenches to a full geotechnical survey of the site. The investigations can reveal the following problems:

- **Filled Ground** – In areas that have been mined it is usual for mine waste to be used to fill over natural ground. These areas are not obvious as they may have been filled many years before. This is a common problem and can usually be overcome. Suitable load bearing strata can usually be found but at greater depths. This may impact on the amount of concrete used to fill the foundations and thus increase the cost of the substructure. Trial holes taken at an early stage can assist in planning and costing the scheme.
- **Shafts** – These are vertical features found frequently in mined areas. Most are in known locations and are noted on the desk study, however, others can be discovered during the site investigations. Shafts are normally capped under the guidance of a structural engineer. The structural caps can usually be

# SK-tec Ltd

## Planning & Technical Services

Planning permission for new houses, developments, extensions, loft conversions and listed building consent.

Architectural drawings and specification for building regulation approval.

Project Management services with free initial consultation/advice and quotation.

**Steve Kendrick**

Tel: 01189 696555

Mobile: 07714 100537

Email: [steve@sk-tec.co.uk](mailto:steve@sk-tec.co.uk)

[www.sk-tec.co.uk](http://www.sk-tec.co.uk)

Oak Tree House, 4 Cody Close, Woodley, Reading, Berkshire RG5 4XN

## ABA Decorating Services



Tel: **01753 686743**

Email: [jasongibbons28@btinternet.com](mailto:jasongibbons28@btinternet.com)

12 Dawn Redwood Close,  
Horton, Slough, Berkshire SL3 9QD

## Painters & Decorators

# Pro-Plumb

**Plumbing & Heating Engineers  
and Design Consultants**

## Luxury Bathrooms



Tel: 0118 947 7408

Mob: 07966 516 979

Email: [proplumbservices@hotmail.co.uk](mailto:proplumbservices@hotmail.co.uk)

8 Norman Road, Caversham,  
Reading, Berkshire RG4 5JN

## May Flooring

Flooring and carpeting specialists

We supply & fit various types of domestic and commercial flooring including vinyl designs (eg Amtico), safety flooring, laminates and a wide range of carpets and vinyls.

Top quality workmanship at competitive prices.

Why not visit our website:

**[www.mayflooring.co.uk](http://www.mayflooring.co.uk)**

or contact us on

**01635 32999**



built over, however, guidance will be required from the structural engineer.

- **Adits** – These are horizontal features found infrequently. Adits will require investigations by a suitably qualified geotechnical engineer and contractor to ascertain the extent and nature of the feature. They will then advise on the best possible course of action.
- **Trial holes** – These are features where shafts and adits have been started but never completed. Trial holes are frequent in these areas and usually easily dealt with. The holes can

usually be excavated and backfilled with concrete once a suitable base is located.

- **Contaminated land** – The filled material is usually excavated mining waste. This material can be contaminated but it is unlikely to be heavy metals associated with coal mining. However, if high levels of sulphates are found they can affect the concrete mix that is required.

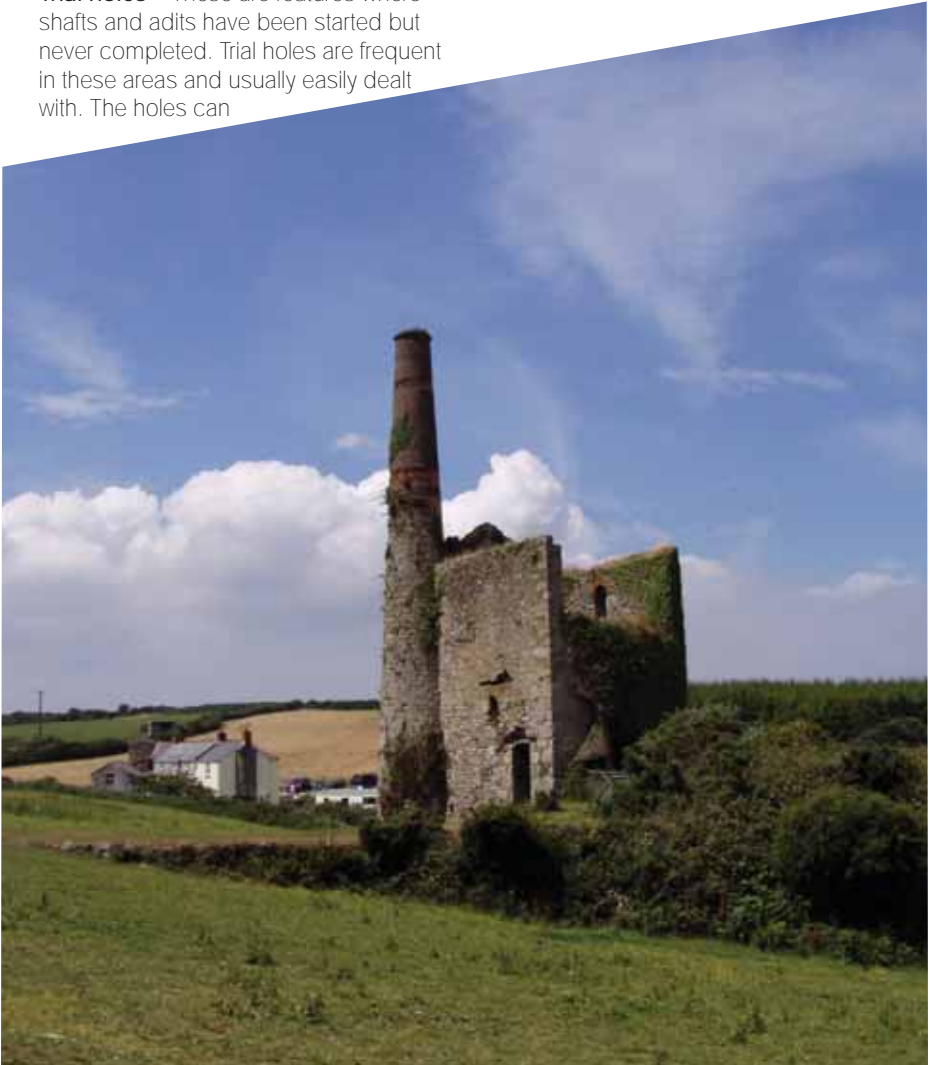

# Coleby & Faulkner

garden design and planting

Passionate about creating beautiful gardens, Jill & Vanessa will guide you through the design, planning and development process helping you achieve the garden of your dreams.

Whether you have a small town courtyard, or spacious country garden, we can help with anything from simple planting advice to a complete re-design and build.

Call Jill 01628 482820 or Vanessa 01628 477685  
or email [info@colebyandfaulkner.co.uk](mailto:info@colebyandfaulkner.co.uk)



design and development : project management : planting specialists : consultancy and sourcing

[www.colebyandfaulkner.co.uk](http://www.colebyandfaulkner.co.uk)



8 Durham Road  
Feltham  
Middlesex  
TW14 0AD

## K.D. SURI BUILDERS LTD NEW BUILD

*Extensions – Loft Conversions  
Renovations – Plumbing  
Carpentry – Electrical Work*



**Tel: 020 8751 5555**

**Mob: 07956 406031**

**Fax: 020 8707 4992**

**Email: [kdsuri@hotmail.co.uk](mailto:kdsuri@hotmail.co.uk)**



- Design and Planning Services
- Local Authority Consultations
- Free site visits and Advice
- Project Management
- Fixed Contract Pricing
- Full Construction
- Qualified Engineers – Gas Safe Part P
- Full Construction
- Referencing upon request

Telphin Garage Conversions Ltd. is a Specialist Building Company with offices in Berkshire and Surrey Covering:

- Berkshire
- Hampshire
- Surrey
- West Sussex
- West London

*If you are considering converting your garage, you need to understand the process and costs, then Contact us: Email: [telphins@btinternet.com](mailto:telphins@btinternet.com)  
[www.telphin.co.uk](http://www.telphin.co.uk)*



## *David Taylor Design Services*

- PLANNING APPLICATIONS
- EXTENSIONS
- LOFT CONVERSIONS
- BUILDING CONTROL APPLICATIONS
- NO OBLIGATION FREE SITE VISIT

We will on your behalf liaise with your local authority, for pre application advice and all relevant correspondence, acting as your agent for the planning application and building control application.

We specialise in domestic house extensions and alterations, including loft conversions, conservatories, etc. New houses, or complete rebuild / replacements undertaken.

David Taylor Design Services can also carry out planning appeals on your behalf.

We will be happy to visit you to discuss and advise on any project, large or small, free of charge.

**01344 777871 / 07971 411897**  
**email: dt455@aol.com**

Sandhurst, Berkshire GU47 8LT

## **Purple Plumbing** *Plumbers*

*All Aspects of Plumbing  
24 Hour Call Out  
Supply and Fit or Fit Only  
Leaks, Blockages, Burst Pipes  
Bathroom Design & Installation*

Tel: **01635 862662**

Email:

**calderhoath@btinternet.com**

2, Goldsmith Close, Thatcham,  
Berkshire RG18 3UF

## *Barkham Construction*

**HOME IMPROVEMENT AND  
EXTENSION SPECIALISTS**

Services we offer:

- Renovations & Refurbishments
- Loft Conversions
- Garage Conversions
- All Carpentry Work Undertaken

*Tel: 01189 732614*

*Email: mollons@btinternet.com*



**RES**  
**Home Maintenance!**

RES offers top quality home maintenance services. RES is a part P approved contractor and all our work is installed to the 17th edition of the IEE Wiring Regulations and is fully insured and guaranteed. Over the years RES has built a reputation for providing work of the highest quality at a very competitive price. We take real pride in our work, and as such, we are happy to say that our customer satisfaction is second to none.

Free work estimate ● Electrical wiring ● Fire Alarm installation ● Bathroom/Kitchen refitting ● Loft conversion ● New central heating system

Tel: 07723 352 701/ 01189 545 651

Email: [info@230voltages.co.uk](mailto:info@230voltages.co.uk)

Website: [www.230voltages.co.uk](http://www.230voltages.co.uk)





**Specialists in Renovation & Restoration Work**

Charta Construction is a well established company with a reputation for quality work spanning some 30 years within the county of Berkshire.

We offer a diverse range of services and pool some of the best professionals in the industry, ensuring the highest standards are met in delivering quality in all aspects of our work to meet the standards you would come to expect.

Our reputation has been built on years of experience in delivering quality work, which is our standard bearer and a reference by which you can measure us through the clientele that we have served.

Why not give us a call and let us guide you to fulfil your needs and expectations.

**Tel: 01189 345612**

**Mob: 07711 652346**

**Email: [trevor@charta.fsbusiness.co.uk](mailto:trevor@charta.fsbusiness.co.uk)**

**2 The Pines, Twyford, Berkshire, RG10 9PA**

## John F. Dick

Architectural Consultants  
*"50 Years in Architecture"*

*Providing a fast, accurate  
and affordable service*

14 Westfield Road, Winnersh  
Wokingham, Berkshire, RG41 5ER

Tel: 01189 773370

Mob: 07813 662612

Email: [jfdarchcons@aol.com](mailto:jfdarchcons@aol.com)

[www.jfdarchcons.webeden.co.uk](http://www.jfdarchcons.webeden.co.uk)

## The Loft Conversion Company

60 Grasmere Avenue,  
Crowthorne Business Estate,  
Tilehurst, Reading,  
Berkshire RG30 6XX

**Tel: 01189 453469**

**Email: [lofcoco@aol.com](mailto:lofcoco@aol.com)**



*excellence in construction*

Specialists in domestic extensions  
and alterations.

01189 773839 – 01344 774035

[enquiries@quoinconstruction.com](mailto:enquiries@quoinconstruction.com)

[www.quoinconstruction.com](http://www.quoinconstruction.com)



# Contacts

## Wokingham Borough Council

Building Control  
P O Box 155  
Civic Offices  
Shute End  
Wokingham  
Berks  
RG40 1WW

Helpdesk: 0118 974 6376

Fax: 0118 974 6385

Email: [building.control@wokingham.gov.uk](mailto:building.control@wokingham.gov.uk)

Website: [www.wokingham.gov.uk](http://www.wokingham.gov.uk)

---

We very gratefully acknowledge the support of the firms whose advertisements appear throughout this publication.

As a reciprocal gesture we have pleasure in drawing the attention of our readers to their announcements.

It is necessary however for it to be made clear that, whilst every care has been taken in compiling this publication and the statements it contains, neither the promoter involved nor the Publisher can accept responsibility for any inaccuracies, or for the products or services advertised.

Designed and published by Ten Alps Publishing, Trelawney House, Chestergate, Macclesfield, Cheshire SK11 6DW. Tel: (01625) 613000.  
[www.tenalpspublishing.com](http://www.tenalpspublishing.com) Ref: BTC (November 2010)



[www.wokingham.gov.uk](http://www.wokingham.gov.uk)

